EXHIBIT C

Plat Indicating the Longitude
and Latitude of Each Well
Drilled to the Pool to Be Spaced
Scale: 1,320 Feet to an Inch

Pulaski Accumulation
 Hilcorp Energy Company
 Pulaski Township
 Lawrence County, PA

Trumbull

Mercer

HEC 110-H

HEC 111-H

Ohio

Pennsylvania

Mahoning

PULASKI-KINKELA North

Lawrence

PULASKI-KINKELA South

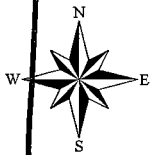

Legend

- XY's
- Proposed Units
- Third Party
- HEC Drilled
- Unleased
- HEC Unit

Not to scale.
 Full scale map included
 with the Original.

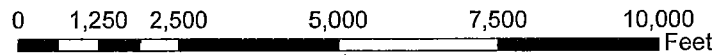

Label	X	Y
0	1251097.42	361957.12
1	1247974.34	348250.06
2	1250634.18	347586.88
3	1248060.93	354136.03
4	1248076.67	354146.38
5	1248082.39	354577.85
6	1247909.13	354803.24
7	1247622.76	354577.17
8	1245338.99	354644.19
9	1244645.11	353720.02
10	1244206.21	353736.18
11	1243907.53	353897.08
12	1242844.51	354026.61
13	1242786.86	354078.29
14	1242543.49	354707.82
15	1242563.30	354809.11
16	1242677.90	354823.50
17	1243153.68	355545.88
18	1242388.28	355562.13
19	1242410.99	356066.71
20	1241732.42	356077.03
21	1241509.06	354393.12
22	1241506.27	354345.35
23	1241515.53	352766.49
24	1241061.36	352782.54
25	1241059.70	352754.97
26	1240484.89	352613.18
27	1240430.80	352718.62
28	1239974.94	352507.72
29	1239732.41	352987.12
30	1239689.96	352984.57
31	1236958.36	353037.51
32	1237312.02	363549.79
33	1239888.92	363553.77
34	1239886.57	362690.13
35	1242993.06	362578.75
36	1243079.03	364577.88
37	1244110.48	363976.29
38	1244201.91	364780.61
39	1246974.36	364920.49
40	1246907.06	363333.14
41	1246758.55	363156.22
42	1246910.05	363099.38
43	1246908.67	363062.46
44	1247086.55	362927.47
45	1246764.82	362462.00
46	1246866.30	362392.66
47	1246730.78	362193.18
48	1246794.78	362148.78
49	1246805.69	362118.49
50	1246834.36	362099.98
51	1246860.49	362094.30
52	1246903.25	361938.90
53	1251105.44	361611.43
54	1251041.66	361611.00
55	1250980.55	360202.90
56	1250885.33	360207.39
57	1250887.36	359508.38
58	1251037.58	359496.37
59	1251030.86	358457.67
60	1250850.87	358459.39
61	1250733.89	354721.20
62	1250668.61	354724.94
63	1250568.68	349654.00
64	1250580.53	349575.87
65	1250639.42	349511.03
66	1250672.41	349417.48
67	1249817.43	347622.86
68	1248077.81	354617.74
69	1249820.00	347951.80
70	1249657.63	347953.46
71	1249664.38	348490.18
72	1248665.06	348496.62
73	1248324.01	347999.36
74	1247996.83	349618.96
75	1247972.03	349619.88

Maps Tracing the Thickness of
the Utica & Point Pleasant
Shales Over the Pulaski
Accumulation

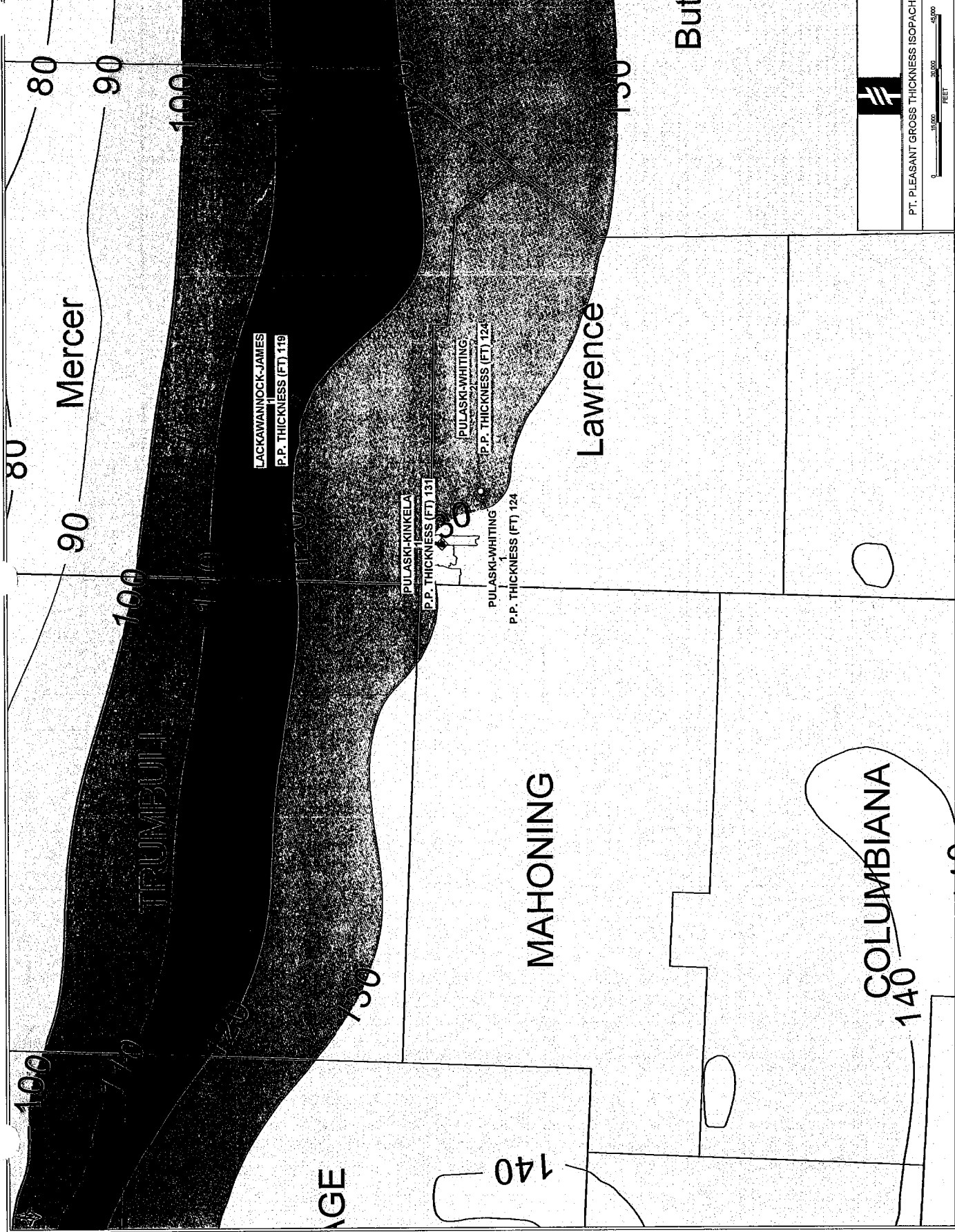
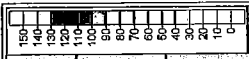

PT. PLEASANT GROSS THICKNESS ISOPACH MAP

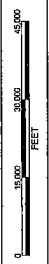

Mercer

Lawrence

MAHONING

COLUMBIANA

Butler

LACKAWANNOCK-JAMES
P.P. THICKNESS (FT) 119

PULASKI-KINKELA
P.P. THICKNESS (FT) 131

PULASKI-WHITING
P.P. THICKNESS (FT) 124

PULASKI-WHITING
P.P. THICKNESS (FT) 124

AGE

140

140

100

110

120

130

130

80

90

100

100

80

90

100

110

120

130

140

150

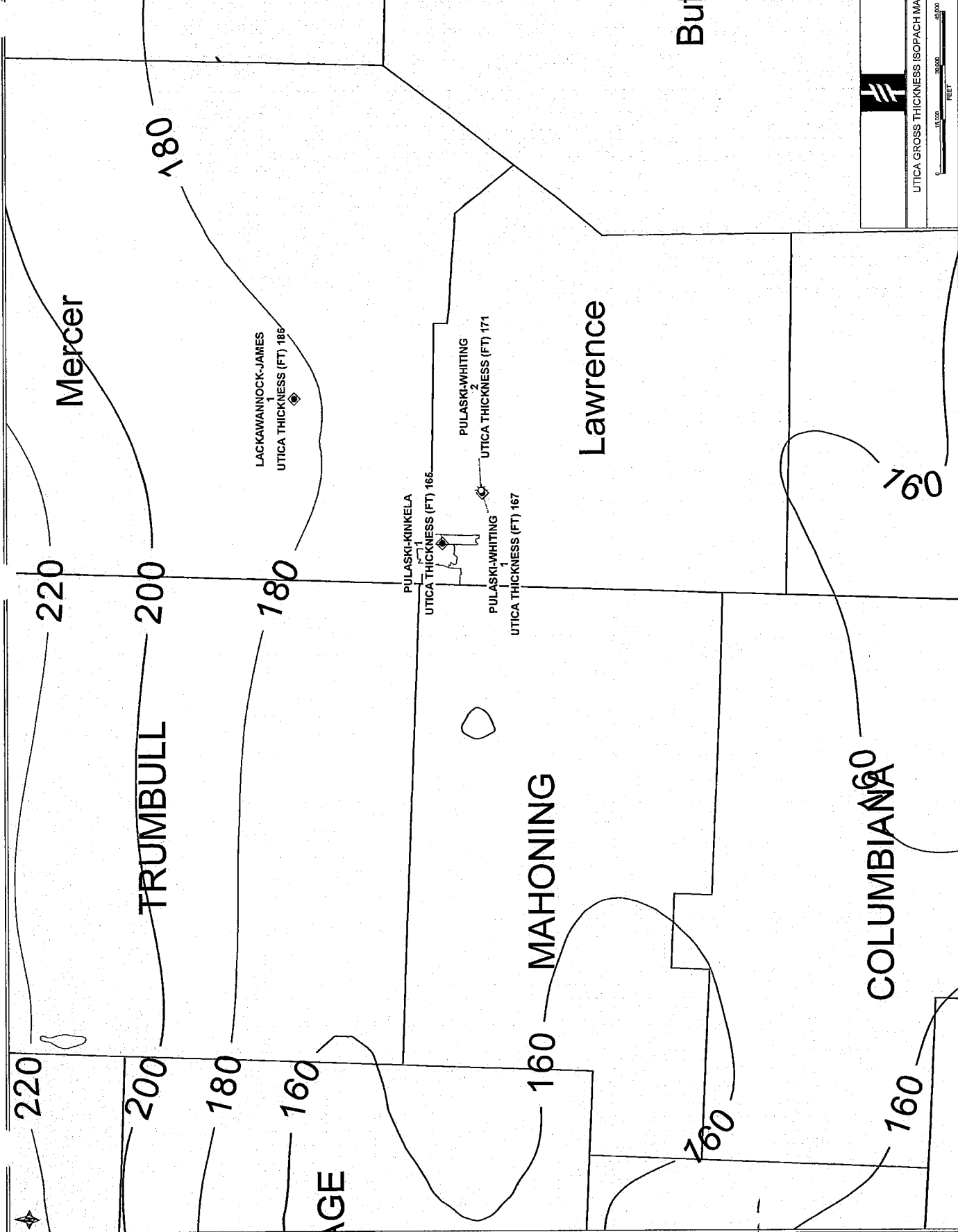
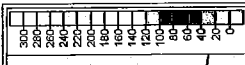

UTICA GROSS THICKNESS ISOPACH MAP

