

ROBESON TOWNSHIP, BERKS COUNTY, PA
STREAM - H21

NOTE: SEE E&S PLANS FOR ALL CROSSING CONDITIONS, NOTES, DETAILS, AND METHODS.

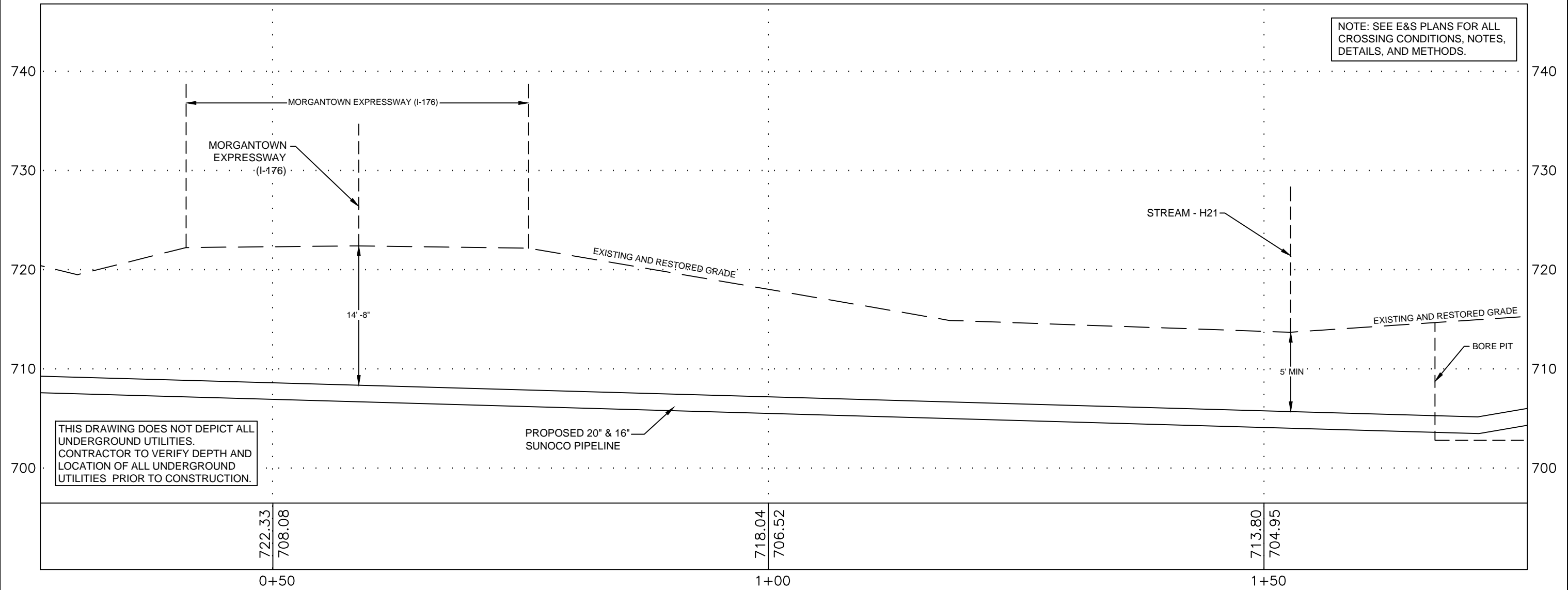

THIS DRAWING DOES NOT DEPICT ALL UNDERGROUND UTILITIES. CONTRACTOR TO VERIFY DEPTH AND LOCATION OF ALL UNDERGROUND UTILITIES PRIOR TO CONSTRUCTION.

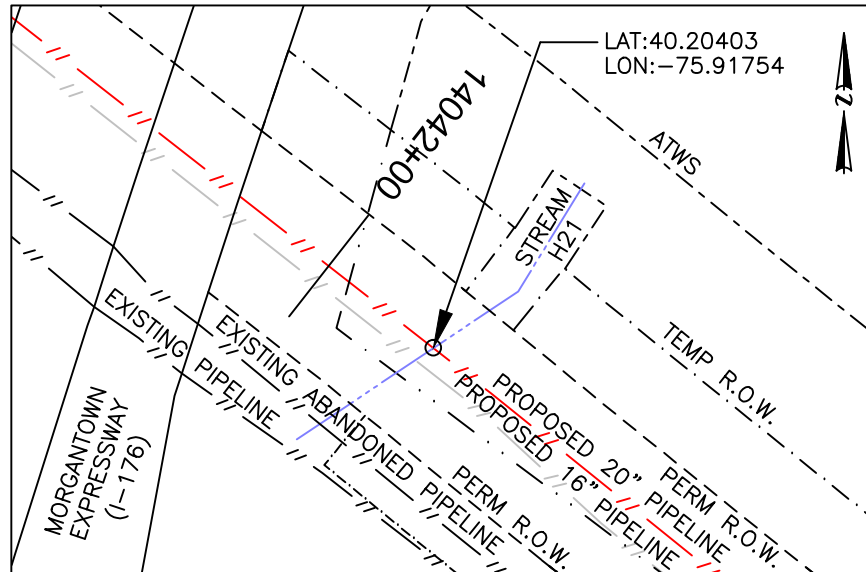

PLAN LEGEND

- PERMANENT R.O.W.
- TEMPORARY WORKSPACE
- ATWS
- R.O.W. SPOIL ONLY
- PROPERTY LINE

PLAN

HORIZ. SCALE : 1" = 60'

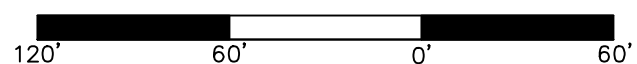

PROFILE LEGEND

- PROPOSED PIPELINE
- EXISTING AND RESTORED GRADE
- EXISTING GRADE ELEV.
- PROPOSED TOP OF PIPE ELEV.

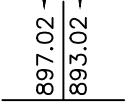

PROFILE

HORIZ. SCALE : 1" = 10'
 VERT. SCALE : 1" = 10'

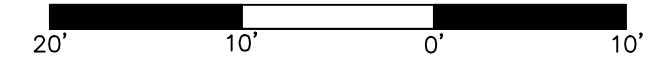

COORDINATE SYSTEM
 PENNSYLVANIA STATE PLANE SOUTH
 NAD 83 US FEET

GRADE SOURCE: SURVEYING DATA AND PASDA CONTOURS

24/7 CONTACT INFO & PIPE MARKER INFO:

SUNOCO PIPELINE L.P.
 525 FRITZTOWN ROAD
 SINKING SPRING, PA 19608
 PHONE NUMBER: 800-786-7440
 NATURAL GAS PIPELINE

CENTERLINE REV DATE: 11-11-2016

SUNOCO
STREAM - H21

ROBESON TOWNSHIP, BERKS COUNTY, PA

11/08/16	SCALE	
REVISED 11/30/16	AS NOTED	DWG: PA-BR-0161.0001-S-H21

Prepared by TRICO SURVEYING AND MAPPING
 BLOOMINGTON, INDIANA
 WWW.TRICOSURVEYING.COM