



APPL. NO. (Department Use Only)

18.50
3p
2n

**CONTRACTUAL CONSENT OF LANDOWNER
(COAL)**

(I) **(We)**, the undersigned, being the owner(s) of 203.0 +/- acres of land located in Paint Township, Somerset County, as (Township, Borough, City) described in the deed(s) recorded in the Recorder of Deeds Office Book(s) and page(s) 1874/1033, 2736/920, 1959/612, 2011/447, 2701/508 and shown by crosshatched lines on the map attached hereto which is signed in the original by the landowner upon which Rosebud Mining Company (Name of Mining Operator)

proposes to engage in surface mining activities for which application for permit will be made to the Department of Environmental Protection and of which application this consent will be made a part, **DO HEREBY ACKNOWLEDGE THAT THE MINING OPERATOR HAS THE RIGHT TO ENTER UPON AND USE THE LAND FOR THE PURPOSES OF CONDUCTING SURFACE MINING ACTIVITIES.** Furthermore, (I) (We), the undersigned, do hereby irrevocably grant to the mining operator and to the Commonwealth of Pennsylvania, the right to enter upon the aforesaid land before beginning the mining activity(ies), during the mining activity(ies) and for a period of five (5) years after the completion or abandonment of the mining activity(ies) for the purposes of inspecting, studying, backfilling, planting and reclaiming the land and abating pollution in accordance with the provisions of the Surface Mining Conservation and Reclamation Act, The Clean Streams Law, and the Coal Refuse Disposal Act, as amended, rules and regulations promulgated thereunder, and the provisions of permit(s) issued to the Mining Operator. (I) (We) do hereby grant in addition to the Commonwealth, for the aforesaid period of time, a right of entry across any adjoining or contiguous lands owned by (us) (me) in order to have access to the land described herein. It is specifically agreed and understood that this contractual consent gives the Commonwealth the right to enter, inspect, study, backfill, plant and reclaim the land and abate pollution therefrom as a matter within the police power but does not obligate the Commonwealth to do so, and does not constitute any ownership interest by the Commonwealth in the aforesaid land.

This Consent shall not be construed to impair any contractual agreement between the Mine Operator and the landowner.
(INSERT ADDITIONAL PROVISIONS OR CROSS OUT)
XX

In witness whereof and intending to legally bind (**myself**) (ourselves), (**my**) (our) heirs, successors and assigns, (I) (we) have hereunto set (**my**) (our) hand(s) and seal this 7th day of July, 2021 (year)

Rosebud Mining Company
LANDOWNER (Print Name)

By:  (Signature) (Seal)

James R. Barker, President
(Print Name)

By: _____ (Signature)

Tax Map No(s). S34-003-004-00
S34-003-005-01
S34-003-005-03
S34-003-005-04
S34-003-012-00
S34-003-015-00

(Print Name)
RECEIVED
JUL 26 2021



Paint Township, Somerset County
Tax Map No. 003
Scale: 1" = 700'

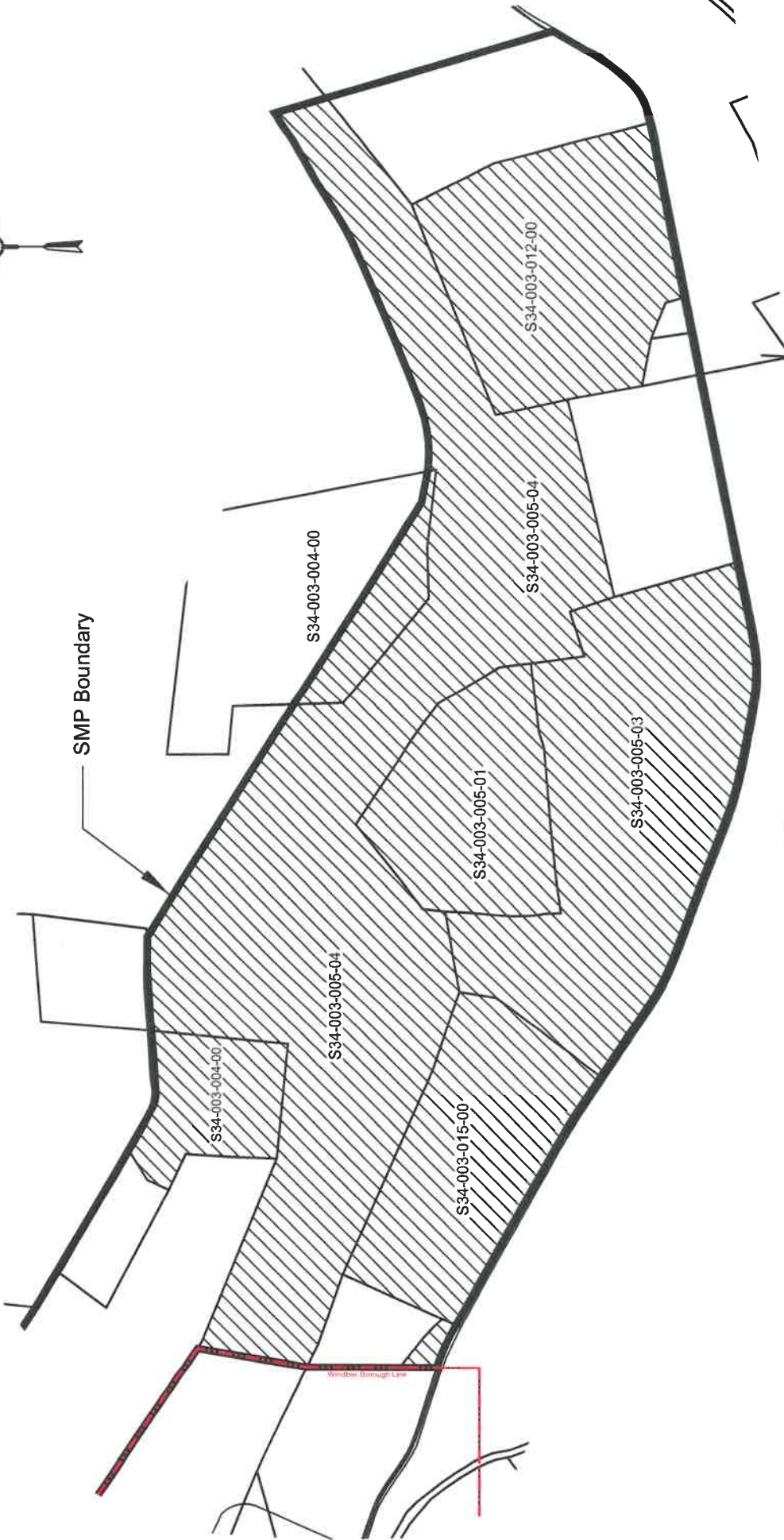

- Tax Map No. S34-003-004-00
- Tax Map No. S34-003-005-01
- Tax Map No. S34-003-005-03
- Tax Map No. S34-003-005-04
- Tax Map No. S34-003-012-00
- Tax Map No. S34-003-015-00

James R. Barker, President
Rosebud Mining Company

ACKNOWLEDGEMENT OF INDIVIDUALS OR PARTNERS

LANDOWNER

STATE OF _____
COUNTY OF _____

ss

On _____, before me, the undersigned Notary, personally appeared

(Name (s))

known to me (or satisfactorily proven) to be the person whose name is subscribed to this instrument, and who acknowledged that _____
(he, she or they)

executed the same and desires it to be recorded.

IN WITNESS WHEREOF, I have hereunto set my hand and official seal.

(SEAL) _____ My Commission Expires: _____
Notary Public (Date)

LANDOWNER

STATE OF _____
COUNTY OF _____

ss

On _____, before me, the undersigned Notary, personally appeared

(Name (s))

known to me (or satisfactorily proven) to be the person whose name is subscribed to this instrument, and who acknowledged that _____
(he, she or they)

executed the same and desires it to be recorded.

IN WITNESS WHEREOF, I have hereunto set my hand and official seal.

(SEAL) _____ My Commission Expires: _____
Notary Public (Date)

ACKNOWLEDGEMENT OF CORPORATIONS

LANDOWNER

STATE OF **PENNSYLVANIA**
COUNTY OF **ARMSTRONG**

ss

On **July 7, 2021**, before me, the undersigned Notary, personally appeared

James R. Barker

(Name(s))

who acknowledged (herself) (**himself**) to be the **President** of
(Title of Person)

Rosebud Mining Company

(Name of Corporation)

corporation, and that (she) (**he**), as such officer, being authorized to do so, executed the foregoing instrument on behalf of the said corporation and desires that this instrument be recorded.

IN WITNESS WHEREOF, I have hereunder set my hand and official seal.

(SEAL)  My Commission Expires: _____
Notary Public (Date)

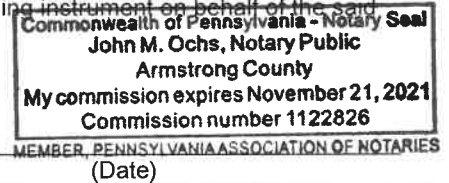

This instrument has been recorded in _____
County, Pennsylvania, this _____ day of _____,
_____(year), at Book _____, Page(s) _____

(Signed) + (Print Name)

(Seal)

SOMERSET COUNTY RECORDER OF DEEDS
PATRICIA A. PEIFER, RECORDER
300 NORTH CENTER AVENUE
SUITE 400
SOMERSET, PENNSYLVANIA 15501
Phone: (814) 445-1547
Fax: (814) 445-1563



RETURN DOCUMENT TO:

ROSEBUD MINING CO
301 MARKET STREET
KITTANNING, PA 16201
ATTN: ENGINEERING DEPARTMENT / BRANDY
M78S3

Instrument Number - 2021005912
Recorded On 7/21/2021 At 11:44:52 AM
*** Instrument Type - LANDOWNER CONSENT**
Invoice Number - 301701 User ID - CMK
*** Total Pages - 4**
*** Customer - ROSEBUD MINING CO**
*** Grantor - ROSEBUD MINING CO**

*** Grantee - ROSEBUD MINING CO**

*** FEES**

STATE WRIT TAX	\$0.50
RECORDING FEES	\$13.00
ROD IMPROVEMENT FUND	\$3.00
COUNTY IMPROVEMENT FUND	\$2.00
TOTAL PAID	\$18.50

This is a certification page

DO NOT DETACH

**This page is now part
of this legal document.**

**I hereby CERTIFY that this
document is recorded in the
Recorder of Deeds Office of
SOMERSET COUNTY, PENNSYLVANIA**

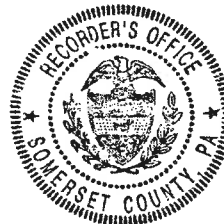

A handwritten signature in cursive script that reads 'Patricia A. Peifer'.

Patricia A. Peifer
Recorder Of Deeds

*** - Information denoted by an asterisk may change during
the verification process and may not be reflected on this page.**

02A058

