

NOTE: STONE FILTER BERM TO BE MAINTAINED AROUND THE PERIMETER OF THE PIT POOL AT ALL TIMES, IN ORDER TO FILTER STORM WATER RUN OFF FROM THE PIT FLOOR INTO THE PIT POOL

- NOTES:**
1. THE DRAINAGE STRUCTURE UNDER W. HARRISBURG AVE. AT ENTRY TO THE QUARRY IS A CONCRETE BOX 8' WIDE X 4' HIGH (WATERWAY OPENING). THE DRAINAGE STRUCTURE UNDER THE DRIVEWAY CONNECTING THE QUARRY & THE PENNSYLVANIA GROWERS PROPERTY IS 8' WIDE X 4' C.I.P. ARCH.
  2. THE PERMITTEE IS HEREBY GRANTED A WAIVER, PER TITLE 25 SECTION 77.504(D)(3), TO CONDUCT SUPPORT ACTIVITIES ONLY WITHIN 300 FEET OF COMMERCIAL BUILDINGS OWNED BY PENNSYLVANIA GROWERS, LLC, AS EXISTED UNDER PREVIOUS MOP NO. 02765M.
  3. THE AERIAL PHOTOGRAPHY AND CONTOURS ARE ACQUIRED FROM A DRONE FLIGHT TAKEN ON APRIL 22, 2024 CONTROLLED BY RIK GPS NAVIO S8 (2021) ON THE NAD83 PENNSYLVANIA STATE PLANES SOUTH ZONE COORDINATE SYSTEM.
  4. OUTSIDE THE FLIGHT, THE IMAGE IS ACQUIRED FROM A 2016 PEMA ORTHOMOGRAPHY FILE, AND THE CONTOURS ARE ACQUIRED FROM 2006 PAMAP PROGRAM 3.2 FT DIGITAL ELEVATION MODEL OF PENNSYLVANIA.
  5. SEE MODULE 23 FOR SEEDINGS AND PLANTING SCHEDULES.

**LEGEND**

- EXISTING 5' CONTOUR
- EXISTING 25' CONTOUR
- PROPERTY LINE
- ADJACENT PROPERTY LINE
- SETBACK
- TOWNSHIP LINE
- ZONING LINE
- RAILWAY
- FENCELINE
- UTILITY POLE
- LIGHT POLE
- EXISTING MONITORING WELL LOCATION
- EXISTING WELL LOCATION
- PRIVATE WATER SUPPLY
- BORE HOLES
- BACKGROUND & PROPOSED MONITORING POINTS
- 1,000 FOOT PERIMETER
- LIMIT OF MINING AS OF 01/01/72
- PROPOSED LIMIT OF MINING AND BOUNDING
- PROPOSED SURFACE MINE PERMIT
- EXISTING SURFACE MINE PERMIT
- EXISTING TREE LINE
- EXISTING EDGE OF WATER
- PROPOSED 5' CONTOUR
- PROPOSED 25' CONTOUR
- DIRECTION AND PROGRESSION OF MINING
- 300' RADIUS TO OCCUPIED STRUCTURE

NOTE: THE 30-ACRE QUARRY EXPANSION AREA IS CLASSIFIED AS PRIMARY AGRICULTURAL LAND, OVERBURDEN BERMS TO BE LABELED AS PRIME FARMLAND SOILS.

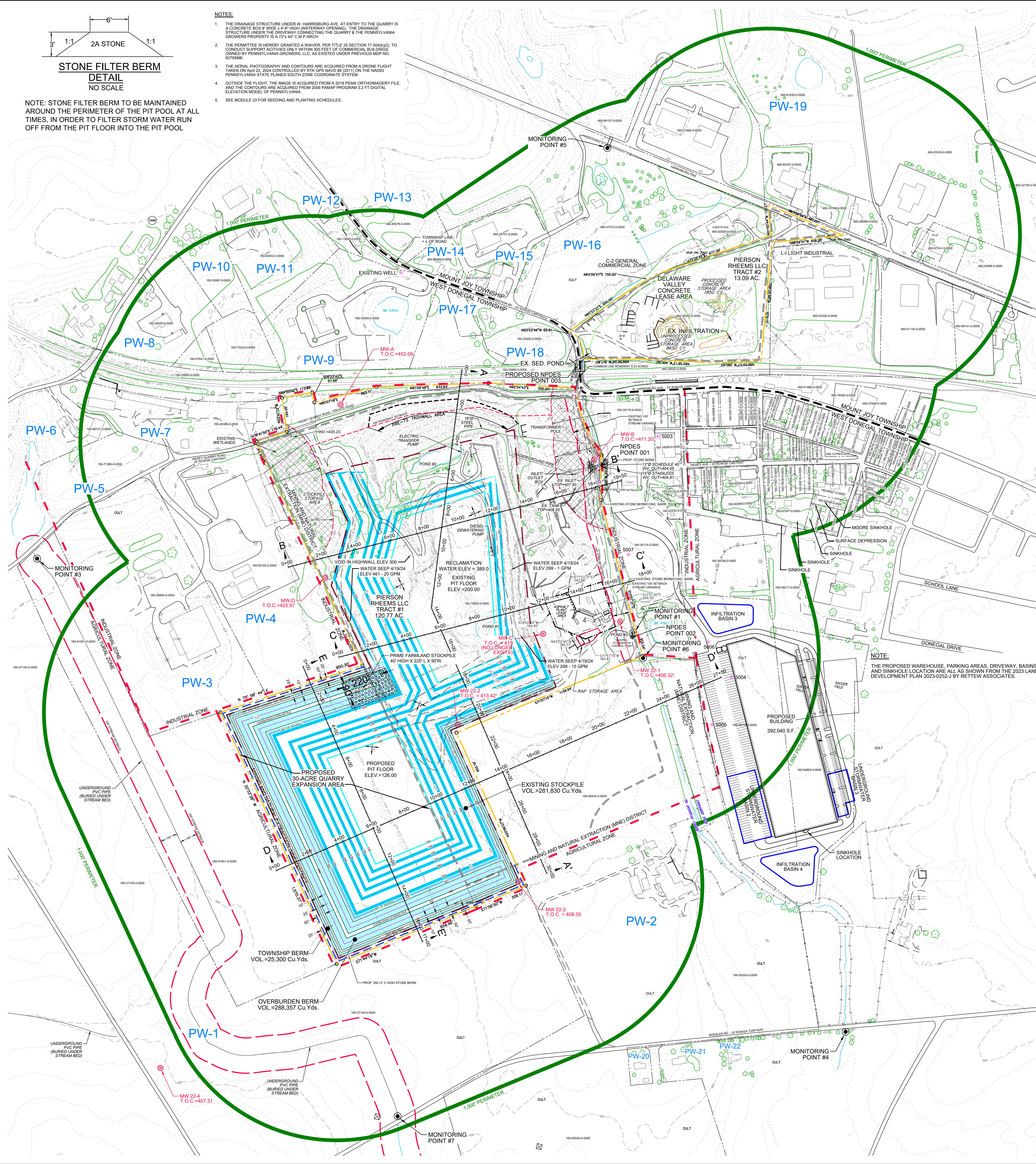

**Akens Engineering Associates, Inc.**  
 219 E. Main St. Shermansstown, Pa. 17011  
 (P) 717-975-9833 (F) 717-975-5507  
 www.akensengineering.com  
 "Providing Quality Engineering & Surveying Services since 1983."

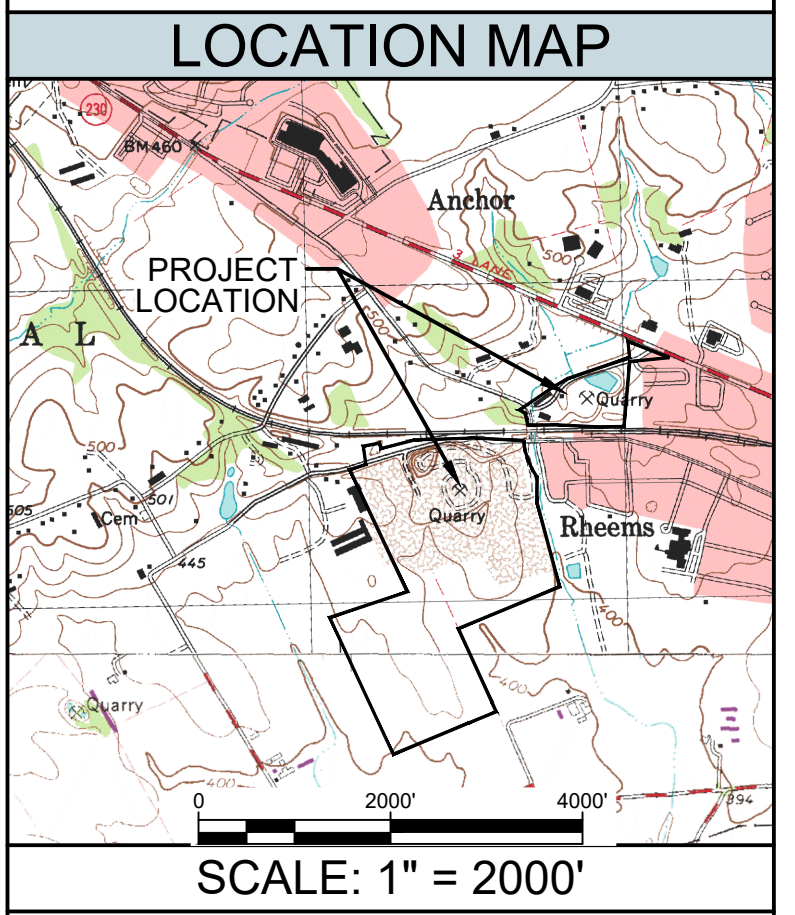

SCOTT WILLIAM AKENS  
 ENGINEER  
 REG. # 14

I hereby certify that this plan is correct and accurate to the best of my knowledge.

SCOTT W. AKENS  
 Professional Engineer, PE073141  
 Submitted on this 24th day of April, 2024.

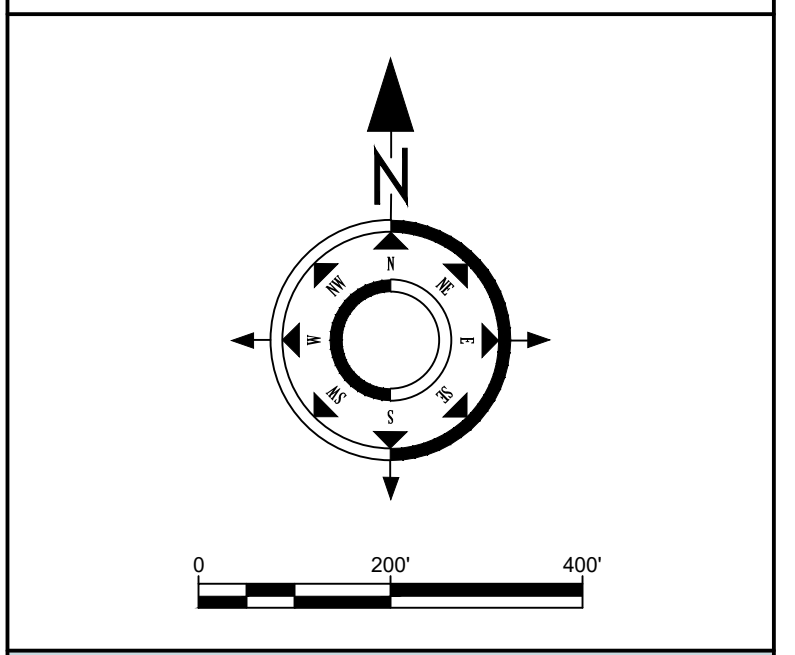

**REVISIONS:**

ADDRESS PADEP 4112/24 COMMENT LETTER - 05/28/24
---

**EXHIBIT 9 OPERATIONS MAP**

SURFACE MINE PERMIT NO. 36080301  
 NPDES PERMIT NO. PA 0224651  
 AUTHORIZATION TO MINE PERMIT NO. 6980-36080301-01

**PIERSON RHEEMS LLC QUARRY OPERATIONS**

WEST DONEGAL & MT JOY TOWNSHIPS  
 LANCASTER COUNTY, PA

SCALE:	SHEET NUMBER:
1" = 200'	4 of 6
PLAN DATE:	
APRIL 24, 2024	
FILE NAME:	

X:\240-1-51 Expansion\Drawing\240-1-51 Base.dwg