

ROAD SPECIFIC CONSTRUCTION SEQUENCE:

1. AT LEAST 7 DAYS PRIOR TO STARTING EARTH DISTURBANCE ACTIVITIES, INCLUDING CLEARING AND GRUBBING, THE OWNER AND/OR OPERATOR SHALL INVITE CONTRACTORS, ENVIRONMENTAL INSPECTORS, THE LANDOWNER, APPROPRIATE MUNICIPAL OFFICIALS, THE E&S PLAN PREPARER, THE PSM PLAN PREPARER, THE LICENSED PROFESSIONAL RESPONSIBLE FOR OVERSIGHT OF CRITICAL STAGES OF IMPLEMENTATION OF THE PSM PLAN, AND A REPRESENTATIVE FROM THE LOCAL CONSERVATION DISTRICT TO AN ON-SITE PRE-CONSTRUCTION MEETING.
2. AT LEAST 3 DAYS PRIOR TO STARTING EARTH DISTURBANCE ACTIVITIES, OR EXPANDING INTO AN AREA PREVIOUSLY UNMARKED, THE PENNSYLVANIA ONE CALL SYSTEM INC. SHALL BE NOTIFIED AT 1-800-242-1776 FOR THE LOCATION OF EXISTING UNDERGROUND UTILITIES.
3. HOLD PRE-CONSTRUCTION CONFERENCE WITH THE ENVIRONMENTAL INSPECTORS, LOCAL COUNTY CONSERVATION DISTRICT (CCD), PADEP AND DESIGN ENGINEER.
4. SURVEY CREWS LOCATE AND STAKE SPECIAL AREAS OF CONCERN (I.E., WETLANDS, STREAMS, CULVERTS, OTHER UTILITIES, ETC.), EDGE OF PROPOSED ACCESS ROAD, AND FIELD LOCATE THE LIMITS OF DISTURBANCE.
5. INSTALL ORANGE CONSTRUCTION FENCE AROUND AREAS TO BE PRESERVED.
6. LOCATE STAGING AREAS AND ACCESS POINTS INCLUDING THE ROCK CONSTRUCTION ENTRANCE. INSTALL COMPOST FILTER SOCK DOWN SLOPE OF THIS AREA.
7. PERFORM TREE CUTTING WHERE REQUIRED. (AREAS WITH TREE CUTTING SHALL BE RESTORED TO MEADOW IN GOOD CONDITION.)
8. INSTALL THE ROCK CONSTRUCTION ENTRANCE AND GRAVEL DRIVEWAY APRON.
9. INSTALL TIMBER MATTING OVER EXISTING CULVERT.
10. REMOVE BRUSH TO EFFECTIVELY INSTALL COMPOST FILTER SOCK, LEVEL SIDE CUTS TO GRANT ACCESS FOR VEHICLES AND WORKERS TO SAFELY PERFORM THE INSTALLATION OF COMPOST FILTER SOCK.
11. INSTALL COMPOST FILTER SOCK AS DEPICTED ON THE E&S PLAN.
12. APPLY STABILIZATION MEASURES IMMEDIATELY TO DISTURBED AREAS DUE TO THE INITIAL CLEARING AND INSTALLATION OF COMPOST FILTER SOCK.
13. THE COMPLIANCE MANAGER SHALL PROVIDE PADEP AT LEAST THREE DAYS' NOTICE PRIOR TO BULK EARTH DISTURBANCE AND UPON COMPLETED INSTALLATION OF COMPOST FILTER SOCK.
14. IF APPLICABLE, INSTALL SECURITY FENCE. THE NECESSITY OF A SECURITY FENCE WILL BE AT THE DISCRETION OF THE CONTRACTOR.
15. PROCEED WITH MAJOR CLEARING AND GRUBBING.
16. BEGIN CONSTRUCTION STAKING FOR LAYOUT OF ACCESS ROAD.
17. BEGIN GRADING AND STRIP AND STOCKPILE TOPSOIL; INSTALL COMPOST FILTER SOCK AROUND STOCKPILES. SOIL STOCKPILE AREAS TO SUPPORT THE ACCESS ROADS SHALL BE LOCATED WITHIN THE AREA OF MINIMUM DISTURBANCE/REDUCED GRADING FOR THE SAME ACCESS ROAD THAT WAS STRIPPED, OR WITHIN THE PIPELINE ROW. STOCKPILED SOIL SHALL NOT EXCEED 35 FEET IN HEIGHT, HAVE MAXIMUM SIDE SLOPES OF 2:1, AND BE SURROUNDED BY 12" COMPOST FILTER SOCK. EXISTING EXCAVATED MATERIAL THAT IS NOT TO BE REUSED IN THE WORK AREA IS TO BE IMMEDIATELY REMOVED FROM THE SITE AND PROPERLY DISPOSED OF AT AN APPROVED FACILITY OR PERMITTED WASTE AREA.
18. IMMEDIATELY STABILIZE THE ACCESS ROAD WITH GEOTEXTILE AND GRAVEL SURFACING WHERE INDICATED IN THE E&S PLANS.
19. UPON TEMPORARY CESSATION OF AN EARTH DISTURBANCE ACTIVITY OR STAGE OF AN ACTIVITY WHERE THE CESSATION OF EARTH DISTURBANCE ACTIVITIES WILL EXCEED FOUR DAYS, THE DISTURBED AREA SHALL BE IMMEDIATELY SEEDED, MULCHED, OR OTHERWISE PROTECTED FROM ACCELERATED EROSION AND SEDIMENTATION PENDING FUTURE EARTH DISTURBANCE ACTIVITIES. FOR AN EARTH DISTURBANCE ACTIVITY OR STAGE OF AN ACTIVITY TO BE CONSIDERED TEMPORARILY STABILIZED, THE DISTURBED AREAS SHALL BE COVERED BY A MINIMUM UNIFORM COVERAGE OF MULCH AND SEED, WITH A DENSITY CAPABLE OF RESISTING ACCELERATED EROSION AND SEDIMENTATION WHICH TEMPORARILY MINIMIZES ACCELERATED EROSION AND SEDIMENTATION. TEMPORARY STABILIZATION WILL NOT OCCUR ON ACTIVE VEHICULAR TRAVEL WAYS WITHIN THE RIGHT-OF-WAY. THE SITE ENVIRONMENTAL INSPECTOR WILL LOG DAILY ACTIVITY WITHIN THE LIMITS OF DISTURBANCE AND NOTIFY THE CONTRACTOR OF AREAS REQUIRING TEMPORARY STABILIZATION (I.E., AREAS WHERE WORK HAS CEASED FOR AT LEAST FOUR DAYS).
20. ONCE THE TEMPORARY ACCESS ROAD IS NO LONGER NECESSARY, REMOVE GRAVEL AND GEOTEXTILE FABRIC FROM THE TEMPORARILY IMPROVED SECTIONS OF THE ACCESS ROAD AND DISPOSE OF THE MATERIALS AT A SUITABLE DISPOSAL OR RECYCLING SITE IN COMPLIANCE WITH LOCAL, STATE, AND FEDERAL REGULATIONS.
21. LOOSEN AND DE-COMPACT TOPSOIL THROUGHOUT THE TEMPORARILY IMPROVED SECTIONS OF THE ACCESS ROAD. REPLACE STOCKPILED TOPSOIL AND GRADE THE DISTURBED AREAS TO MATCH PRE-CONSTRUCTION CONDITIONS. IMMEDIATELY FERTILIZE, SEED AND STABILIZE AREAS AT FINISHED GRADE. MAINTAIN THE COMPOST FILTER SOCK UNTIL SITE WORK IS COMPLETE AND UNIFORM 70% PERENNIAL VEGETATIVE COVER IS ESTABLISHED.
22. UPON COMPLETION OF EARTH DISTURBANCE ACTIVITIES AND PERMANENT STABILIZATION OF DISTURBED AREAS, THE OWNER SHALL CONTACT THE LOCAL CCD FOR AN INSPECTION PRIOR TO THE REMOVAL OF THE COMPOST FILTER SOCK. VEGETATED AREAS MUST ACHIEVE A MINIMUM UNIFORM 70% PERENNIAL COVER OVER THE ENTIRE DISTURBED AREA TO BE CONSIDERED STABILIZED. ROADWAYS AND PARKING AREAS SHOULD HAVE AT LEAST A CLEAN SUBBASE IN PLACE TO BE CONSIDERED STABILIZED.
23. UPON LOCAL CCD AND TRANSCO APPROVAL OF STABILIZATION AND RE-VEGETATION, EITHER:
 - A. LEAVE THE COMPOST FILTER SOCK IN PLACE, CUT OPEN THE MESH, AND SPREAD THE MULCH AS A SOIL SUPPLEMENT; OR
 - B. REMOVE THE COMPOST FILTER SOCK, STABILIZE AREAS DISTURBED BY REMOVAL, AND PROPERLY DISPOSE/RECYCLE THE COMPOST FILTER SOCK.
24. REMOVE ORANGE CONSTRUCTION FENCING AND SECURITY FENCE.
25. UPON COMPLETION OF EARTH DISTURBANCE ACTIVITIES, REMOVAL OF COMPOST FILTER SOCK AND PERMANENT STABILIZATION OF DISTURBED AREAS, THE OWNER SHALL CONTACT THE LOCAL CCD FOR A FINAL INSPECTION.

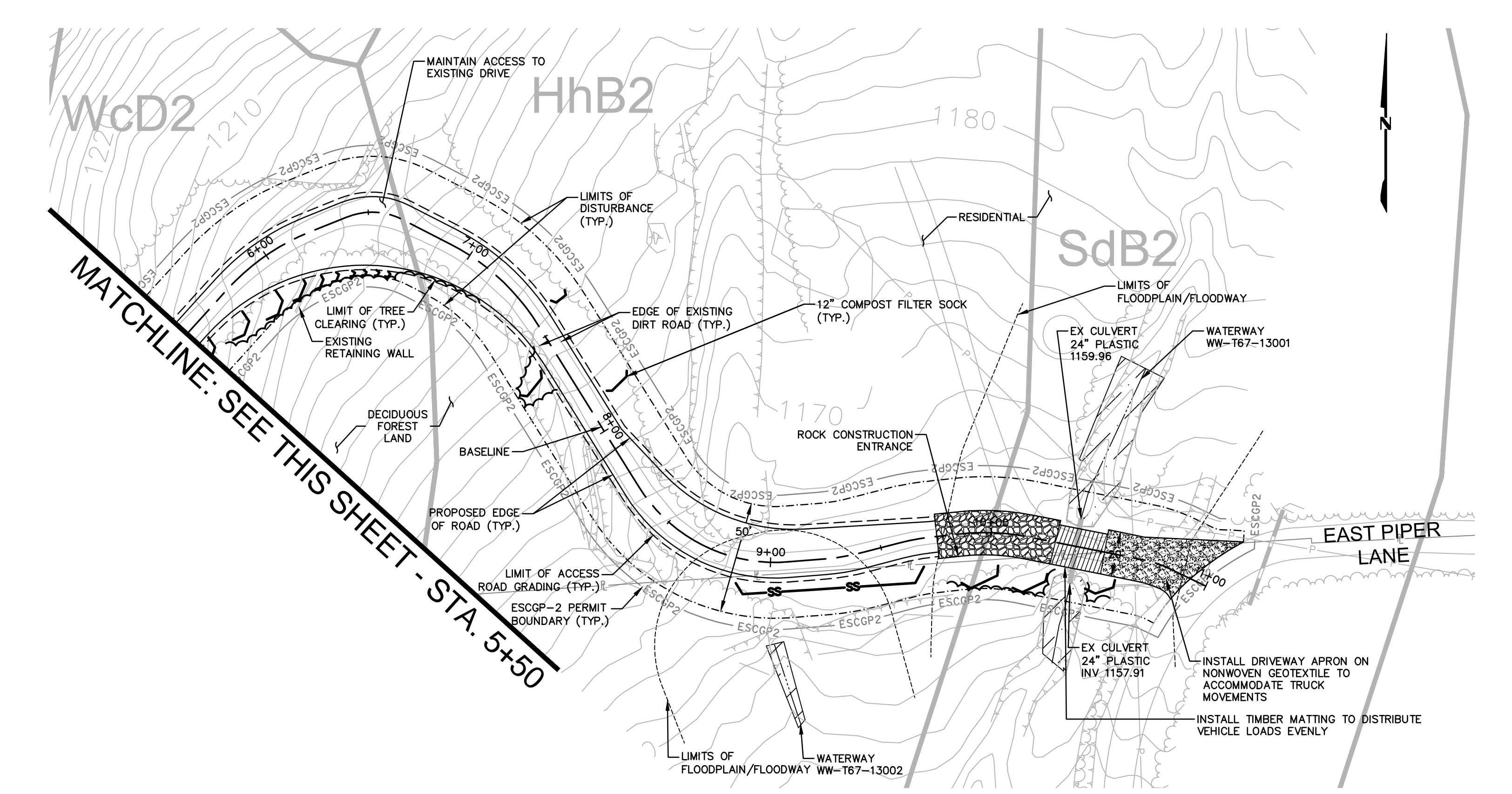
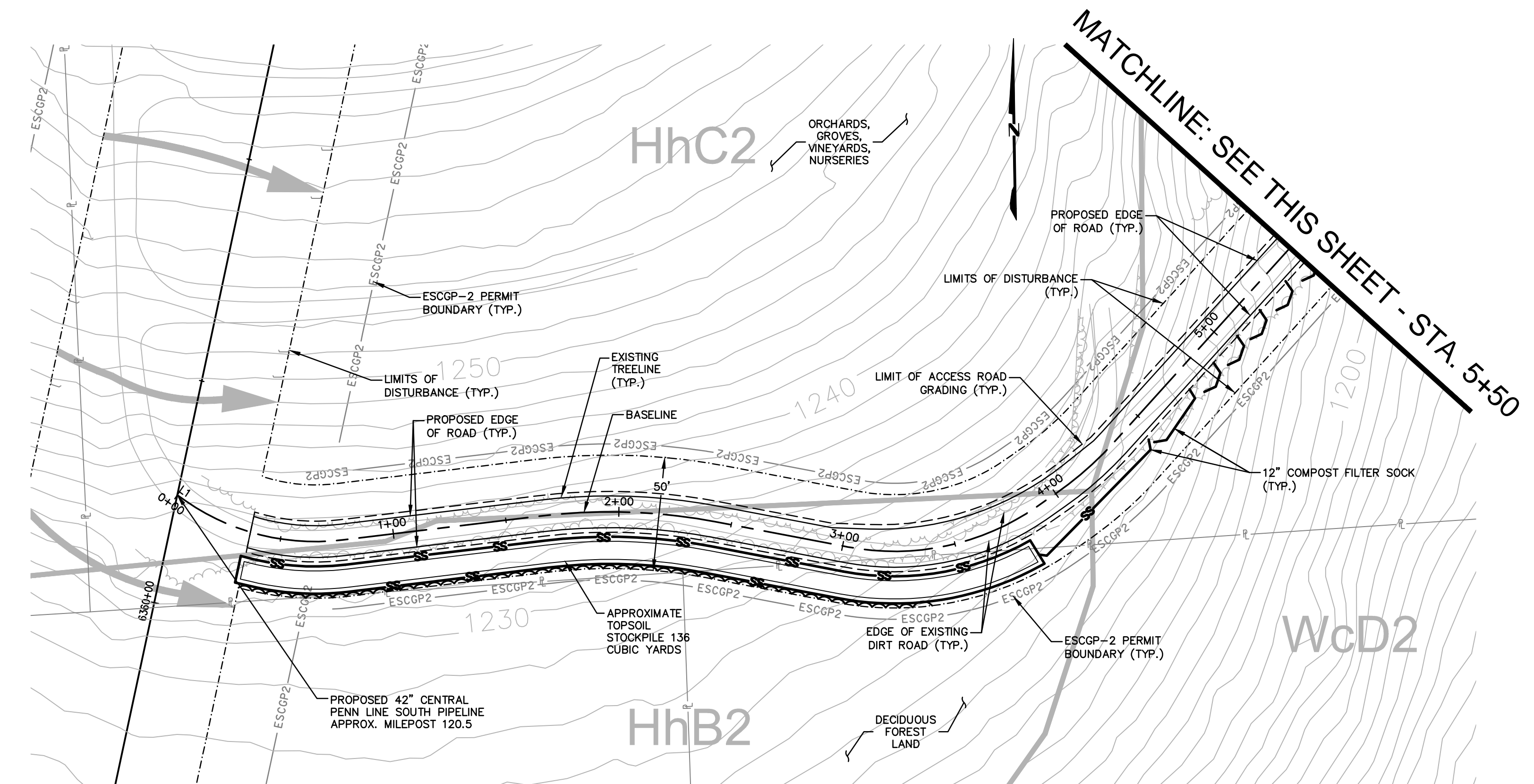

105 COORDINATION NOTE:

THE CALCULATION OF FILL VOLUMES PROVIDED WITHIN THE CHAPTER 105 APPLICATION IS BASED ON THE EXTENT OF THE ACCESS ROAD LOD WITHIN THE FLOODPLAIN/FLOODWAY TO ACCOUNT FOR WORST-CASE FIELD SCENARIOS REQUIRING THE ADDITION OF A ONE FOOT-DEPTH OF GRAVEL FOR MAINTENANCE AND/OR MINOR ACCESS ROAD WIDENING FOR IMPROVED ACCESS. AS SUCH, THE FILL VOLUME IS AN OVERESTIMATION AND DOES NOT REFLECT THE ACTUAL VOLUME OF FILL REQUIRED BY THE CURRENT ACCESS ROAD DESIGN, AS PRESENTED WITHIN THE CHAPTER 102 PERMIT. THE INCLUSION OF THE OVERESTIMATED FILL VOLUMES WITHIN THE CHAPTER 105 APPLICATION LIMITS FUTURE REVISIONS TO THE CHAPTER 105 APPLICATION DUE TO MINOR FIELD ADJUSTMENTS, CONVERSELY, REVISIONS TO ACCESS ROAD DESIGN AFTER THE 102 PERMIT ISSUANCE WILL BE COORDINATED WITH PADEP/CCD.

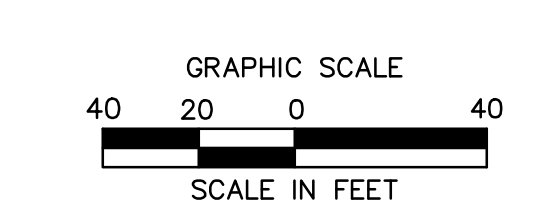

REVISIONS					
NO.	DATE	BY	DESCRIPTION	W.O. NO.	CHK. APP.
0	07/17/2015	BL	ISSUED FOR PADEP SUBMITTAL	1161503	DAK SMK
1	12/02/2015	BL	ISSUED FOR PADEP RESUBMITTAL	1161503	DAK SMK
2	OCT. 2016	BL	PADEP TECHNICAL DEFICIENCY RESPONSE #1	1161503	DAK SMK
3	APRIL 2017	BL	PADEP TECHNICAL DEFICIENCY RESPONSE #2	1161503	DAK SMK
4	AUG. 2017	BL	PADEP TECHNICAL DEFICIENCY RESPONSE #3	1161503	DAK SMK

TRANSCONTINENTAL GAS PIPE LINE COMPANY, LLC					
ATLANTIC SUNRISE PROJECT - PROPOSED 42" CENTRAL PENN LINE SOUTH					
ACCESS ROADS - SOIL EROSION CONTROL PLAN					
PROPOSED TEMPORARY ACCESS ROAD AR-CO-106					
JACKSON TOWNSHIP, COLUMBIA COUNTY, PENNSYLVANIA					
DRAWN BY:	OLC/MS	DATE:	4/2015	ISSUED FOR BID:	SCALE: 1"=40'
CHECKED BY:	DAK	DATE:	06/12/15	ISSUED FOR CONSTRUCTION:	REVISION: 4
APPROVED BY:	SMK	DATE:	07/07/15	DRAWING NUMBER:	24-1600-70-28-A/ LL113_9-AR-CO-106
W.O.:	W01161503				SHEET 3 OF 4

Drawn By & Date/Time: sking Jul 25, 2017 - 12:59pm
 Drawing Location & Name: G:\0851\14\1404609\DWG\020-CPLS\VAR_EC1404609(20N)-IAR-CO-106.dwg

NOTE:
SEE TYPICAL SECTIONS SHEET 3 OF 4 (GENERAL OVERALL SECTION) FOR EXISTING AND PROPOSED FEATURES LEGEND.