

105 COORDINATION NOTE:

THE CALCULATION OF FILL VOLUMES PROVIDED WITHIN THE CHAPTER 105 APPLICATION IS BASED ON THE EXTENT OF THE ACCESS ROAD LOD WITHIN THE FLOODPLAIN/FLOODWAY TO ACCOUNT FOR WORST-CASE FIELD SCENARIOS REQUIRING THE ADDITION OF A ONE FOOT-DEPTH OF GRAVEL FOR MAINTENANCE AND/OR MINOR ACCESS ROAD WIDENING FOR IMPROVED ACCESS. AS SUCH, THE FILL VOLUME IS AN OVERESTIMATION AND DOES NOT REFLECT THE ACTUAL VOLUME OF FILL REQUIRED BY THE CURRENT ACCESS ROAD DESIGN, AS PRESENTED WITHIN THE CHAPTER 102 PERMIT. THE INCLUSION OF THE OVERESTIMATED FILL VOLUMES WITHIN THE CHAPTER 105 APPLICATION LIMITS FUTURE REVISIONS TO THE CHAPTER 105 APPLICATION DUE TO MINOR FIELD ADJUSTMENTS. CONVERSELY, REVISIONS TO ACCESS ROAD DESIGN AFTER THE 102 PERMIT ISSUANCE WILL BE COORDINATED WITH PADEP/CCD.

ROAD SPECIFIC CONSTRUCTION SEQUENCE:

- AT LEAST 7 DAYS PRIOR TO STARTING EARTH DISTURBANCE ACTIVITIES, INCLUDING CLEARING AND GRUBBING, THE OWNER AND/OR OPERATOR SHALL INVITE CONTRACTORS, ENVIRONMENTAL INSPECTORS, THE LANDOWNER, APPROPRIATE MUNICIPAL OFFICIALS, THE E&S PLAN PREPARER, THE P&SM PLAN PREPARER, THE LICENSED PROFESSIONAL RESPONSIBLE FOR OVERSIGHT OF CRITICAL STAGES OF IMPLEMENTATION OF THE P&SM PLAN, AND A REPRESENTATIVE FROM THE LOCAL CONSERVATION DISTRICT TO AN ON-SITE PRE-CONSTRUCTION MEETING.
- AT LEAST 3 DAYS PRIOR TO STARTING EARTH DISTURBANCE ACTIVITIES, OR EXPANDING INTO AN AREA PREVIOUSLY UNMARKED, THE PENNSYLVANIA ONE CALL SYSTEM INC. SHALL BE NOTIFIED AT 1-800-242-1776 FOR THE LOCATION OF EXISTING UNDERGROUND UTILITIES.
- HOLD PRE-CONSTRUCTION CONFERENCE WITH THE ENVIRONMENTAL INSPECTORS, LOCAL COUNTY CONSERVATION DISTRICT (CCD), PADEP AND DESIGN ENGINEER.
- SURVEY CREWS LOCATE AND STAKE SPECIAL AREAS OF CONCERN (E.G., WETLANDS, STREAMS, CULVERTS, OTHER UTILITIES, ETC.), EDGE OF PROPOSED ACCESS ROAD, AND FIELD LOCATE THE LIMIT OF DISTURBANCE.
- INSTALL ORANGE CONSTRUCTION FENCE AROUND AREAS TO BE PRESERVED.
- LOCATE STAGING AREAS AND ACCESS POINTS INCLUDING THE ROCK CONSTRUCTION ENTRANCE. INSTALL SEDIMENT BARRIERS DOWN SLOPE OF THIS AREA.
- STRIP AND STOCKPILE TOPSOIL; INSTALL COMPOST FILTER SOCK AROUND STOCKPILES. SOIL STOCKPILE AREAS TO SUPPORT THE ACCESS ROADS SHALL BE LOCATED WITHIN THE AREA OF MINIMUM DISTURBANCE/REDUCED GRADINGS FOR THE SAME ACCESS ROAD THAT THE TOPSOIL WAS STRIPPED, OR WITHIN THE PIPELINE ROW. STOCKPILED SOIL SHALL NOT EXCEED 35 FEET IN HEIGHT, HAVE MAXIMUM SIDE SLOPES OF 2:1, AND BE SURROUNDED BY 12" COMPOST FILTER SOCK. EXISTING EXCAVATED MATERIAL THAT IS NOT TO BE REUSED IN THE WORK AREA IS TO BE IMMEDIATELY REMOVED FROM THE SITE AND PROPERLY DISPOSED OF AT AN APPROVED FACILITY OR PERMITTED WASTE AREA.
- INSTALL THE ROCK CONSTRUCTION ENTRANCE.
- INSTALL SEDIMENT BARRIERS AS DEPICTED ON THE PIPELINE E&S PLAN.
- THE COMPLIANCE MANAGER SHALL PROVIDE PADEP AT LEAST THREE DAYS' NOTICE PRIOR TO BULK EARTH DISTURBANCE AND UPON COMPLETED INSTALLATION OF THE SEDIMENT BARRIERS.
- IF APPLICABLE, INSTALL SECURITY FENCE. THE NECESSITY OF A SECURITY FENCE WILL BE AT THE DISCRETION OF THE CONTRACTOR.
- UPON TEMPORARY CESSATION OF AN EARTH DISTURBANCE ACTIVITY OR STAGE OF AN ACTIVITY WHERE THE CESSATION OF EARTH DISTURBANCE ACTIVITIES WILL EXCEED FOUR DAYS, THE DISTURBED AREA SHALL BE IMMEDIATELY SEEDED, MULCHED, OR OTHERWISE PROTECTED FROM ACCELERATED EROSION AND SEDIMENTATION PENDING FUTURE EARTH DISTURBANCE ACTIVITIES. FOR AN EARTH DISTURBANCE ACTIVITY OR STAGE OF AN ACTIVITY TO BE CONSIDERED TEMPORARILY STABILIZED, THE DISTURBED AREAS SHALL BE COVERED BY A MINIMUM UNIFORM COVERAGE OF MULCH AND SEED, WITH A DENSITY CAPABLE OF RESISTING ACCELERATED EROSION AND SEDIMENTATION WHICH TEMPORARILY MINIMIZES ACCELERATED EROSION AND SEDIMENTATION. TEMPORARY STABILIZATION WILL NOT OCCUR ON ACTIVE VEHICULAR TRAVEL WAYS WITHIN THE RIGHT OF WAY. THE ON-SITE ENVIRONMENTAL INSPECTOR WILL LOG DAILY ACTIVITY WITHIN THE LIMITS OF DISTURBANCE AND NOTIFY THE CONTRACTOR OF AREAS REQUIRING TEMPORARY STABILIZATION (I.E., AREAS WHERE WORK HAS CEASED FOR AT LEAST FOUR DAYS).
- ONCE THE TEMPORARY ACCESS ROAD IS NO LONGER NECESSARY, REMOVE THE ROCK CONSTRUCTION ENTRANCE FROM THE TEMPORARILY IMPROVED SECTIONS OF THE ACCESS ROAD AND DISPOSE OF THE MATERIALS AT A SUITABLE DISPOSAL OR RECYCLING SITE IN COMPLIANCE WITH LOCAL, STATE, AND FEDERAL REGULATIONS.
- LOOSEN AND DE-COMPACT TOPSOIL THROUGHOUT THE TEMPORARILY IMPROVED PORTIONS OF THE ACCESS ROAD. REPLACE STOCKPILED TOPSOIL AND GRADE THE DISTURBED AREAS TO MATCH PRE-CONSTRUCTION CONDITIONS. IMMEDIATELY FERTILIZE, SEED AND STABILIZE AREAS AT FINISHED GRADE. MAINTAIN COMPOST FILTER SOCK UNTIL SITE WORK IS COMPLETE AND UNIFORM 70% PERENNIAL VEGETATIVE COVER IS ESTABLISHED.
- UPON COMPLETION OF EARTH DISTURBANCE ACTIVITIES AND PERMANENT STABILIZATION OF DISTURBED AREAS, THE OWNER SHALL CONTACT THE LOCAL CCD FOR AN INSPECTION PRIOR TO THE REMOVAL OF THE SEDIMENT BARRIERS. VEGETATED AREAS MUST ACHIEVE A MINIMUM UNIFORM 70% PERENNIAL COVER OVER THE ENTIRE DISTURBED AREA TO BE CONSIDERED STABILIZED. ROADWAYS AND PARKING AREAS SHOULD HAVE AT LEAST A CLEAN SUBBASE IN PLACE TO BE CONSIDERED STABILIZED. IN AGRICULTURAL USE AREAS, AN AREA SHALL BE CONSIDERED TO HAVE ACHIEVED FINAL STABILIZATION IF THE ABOVE CONDITIONS ARE MET OR IF AN AREA EXHIBITS ANY GROUND COVER CONDITIONS NORMALLY ASSOCIATED WITH ACTIVE AGRICULTURAL PRACTICES, INCLUDING BUT NOT LIMITED TO BARE EARTH ON CULTIVATED LAND, TEMPORARY VEGETATIVE COVER ON CULTIVATED LAND, OR PASTURE NOT MEETING A MINIMUM UNIFORM 70% PERENNIAL VEGETATIVE COVER.
- UPON LOCAL CCD AND TRANSCO APPROVAL OF STABILIZATION AND RE-VEGETATION, EITHER:
 - LEAVE THE COMPOST FILTER SOCK IN PLACE, CUT OPEN THE MESH, AND SPREAD THE MULCH AS A SOIL SUPPLEMENT; OR
 - REMOVE THE COMPOST FILTER SOCK, STABILIZE AREAS DISTURBED BY REMOVAL, AND PROPERLY DISPOSE/RECYCLE THE COMPOST FILTER SOCK.
- REMOVE ORANGE CONSTRUCTION FENCING AND SECURITY FENCE.
- UPON COMPLETION OF EARTH DISTURBANCE ACTIVITIES, REMOVAL OF SEDIMENT BARRIERS AND PERMANENT STABILIZATION OF DISTURBED AREAS, THE OWNER SHALL CONTACT THE LOCAL CCD FOR A FINAL INSPECTION.

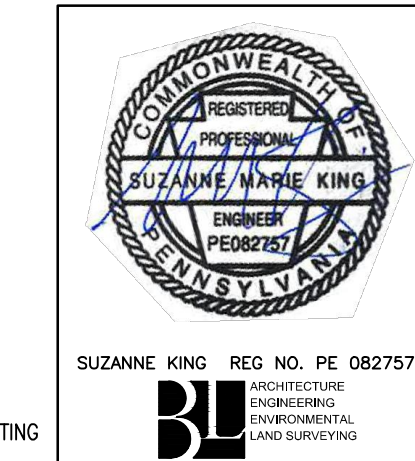
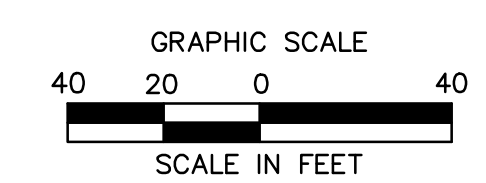
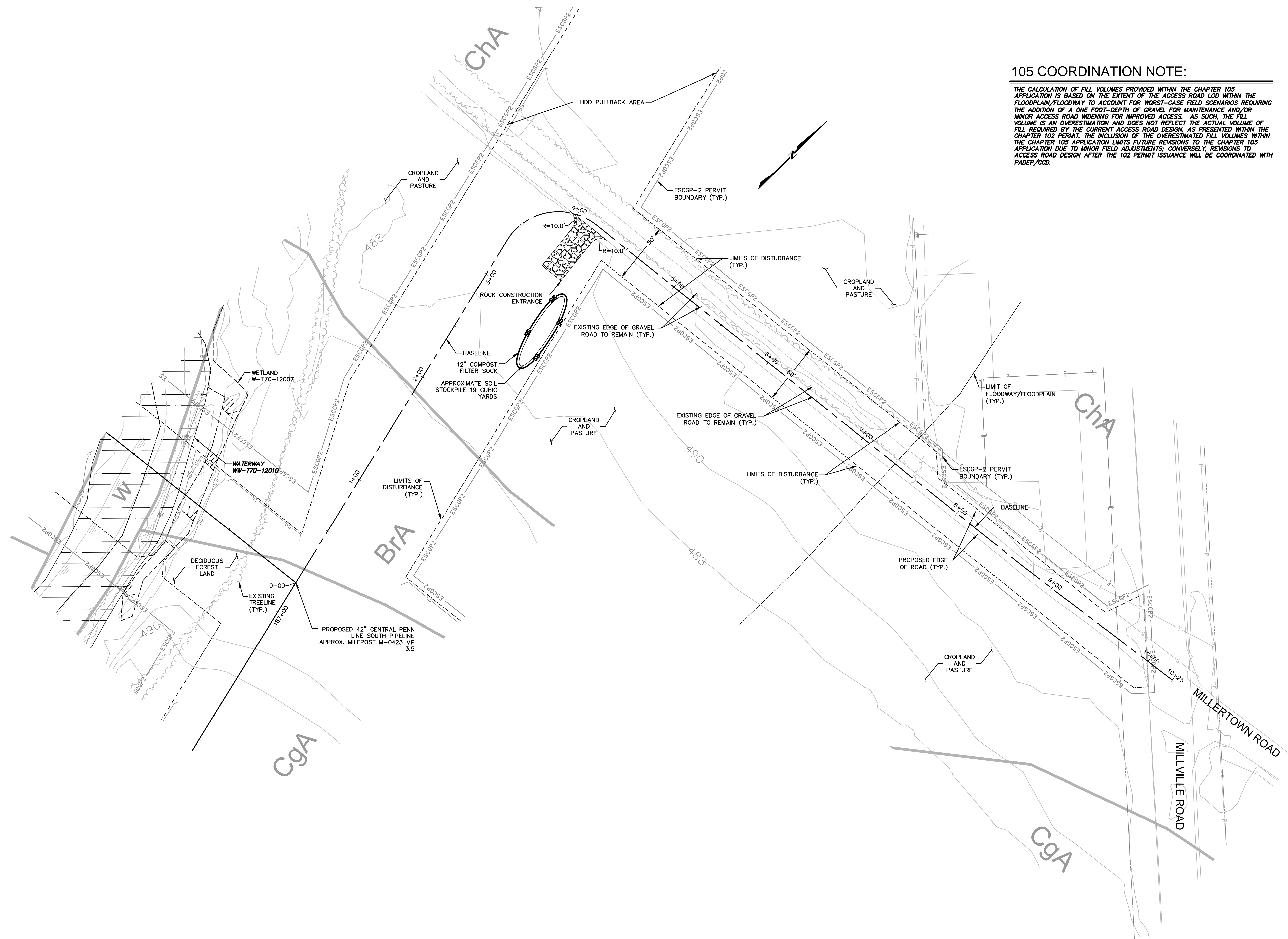

REVISIONS					
NO.	DATE	BY	DESCRIPTION	W.O. NO.	CHK. APP.
0	OCT. 2016	BL	PADEP TECHNICAL DEFICIENCY RESPONSE #1	1161503	DAK SMK
1	APRIL 2017	BL	PADEP TECHNICAL DEFICIENCY RESPONSE #2	1161503	DAK SMK
2	AUG. 2017	BL	PADEP TECHNICAL DEFICIENCY RESPONSE #3	1161503	DAK SMK

TRANSCONTINENTAL GAS PIPE LINE COMPANY, LLC
 ATLANTIC SUNRISE PROJECT - PROPOSED 42" CENTRAL PENN LINE SOUTH

ACCESS ROADS - SOIL EROSION CONTROL PLAN
 PROPOSED TEMPORARY ACCESS ROAD AR-CO-097.1
 MOUNT PLEASANT TOWNSHIP,
 COLUMBIA COUNTY, PENNSYLVANIA

Williams
GAS PIPELINE

DRAWN BY: OLC/MS	DATE: 4/2015	ISSUED FOR BID:	SCALE: 1"=40'
CHECKED BY: DAK	DATE: 06/12/15	ISSUED FOR CONSTRUCTION:	REVISION: 2
APPROVED BY: SMK	DATE: 07/07/15	DRAWING NUMBER: 24-1600-70-28-A/ LL113-9-AR-CO-097.1	SHEET 3 OF 4

Drawn By & Date/Time: sking Jul 26, 2017 - 3:28pm
 Drawing Location & Name: G:\0851\14\1404999\DWG\020-CPLS\VAR_EC\404999\CON-1AR-CO-097.1.dwg

NOTE:
 SEE TYPICAL SECTIONS SHEET 3 OF 4
 (GENERAL OVERALL SECTION) FOR EXISTING
 AND PROPOSED FEATURES LEGEND.