

- NOTES:
1. A TRASH RACK WITH ANTI-VORTEX DEVICE SHALL BE PLACED ON TOP OF PRINCIPAL SPILLWAY RISER. FEED PIPE RISER SHALL BE CAPPED.
 2. AN ALTERNATIVE ARRANGEMENT FOR CONSTRUCTING THE RISER WITH PERFORATIONS ARE PERMISSIBLE PROVIDED APPROPRIATE DESIGN CONSIDERATIONS ARE SATISFIED AS APPROVED BY THE ENGINEER OR QUALITY ASSURANCE ENGINEER.

1 RISER FOUNDATION DETAIL
10B NOT TO SCALE

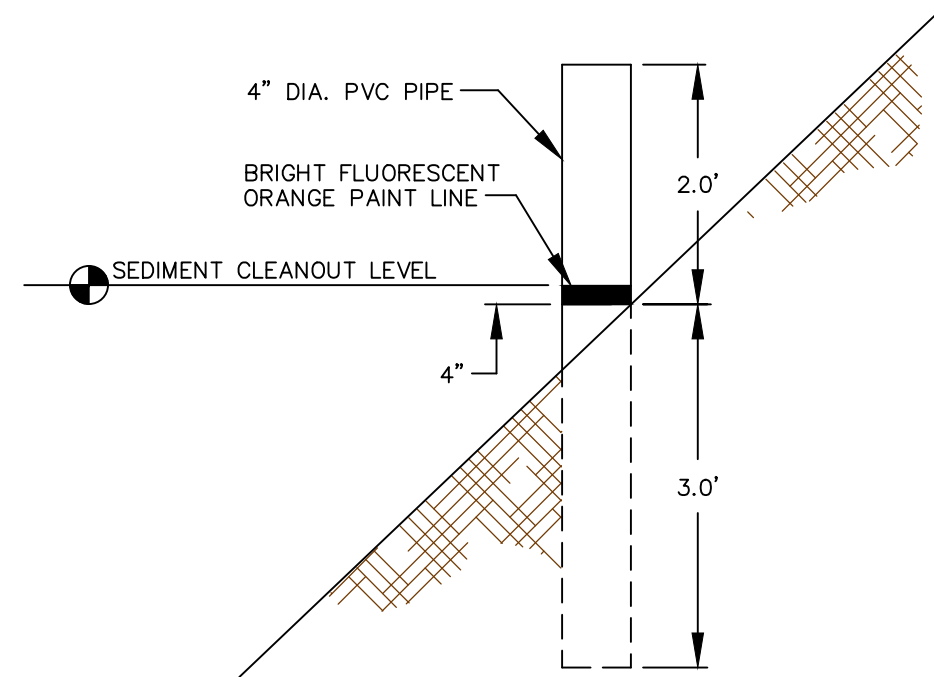

NOTE:
CLEANOUT STAKES MAY BE PLACED AROUND INSIDE PERIMETER OF BASIN AREA TO AID IN IDENTIFYING CLEANOUT LEVEL.

4 CLEANOUT STAKE DETAIL
10B NOT TO SCALE

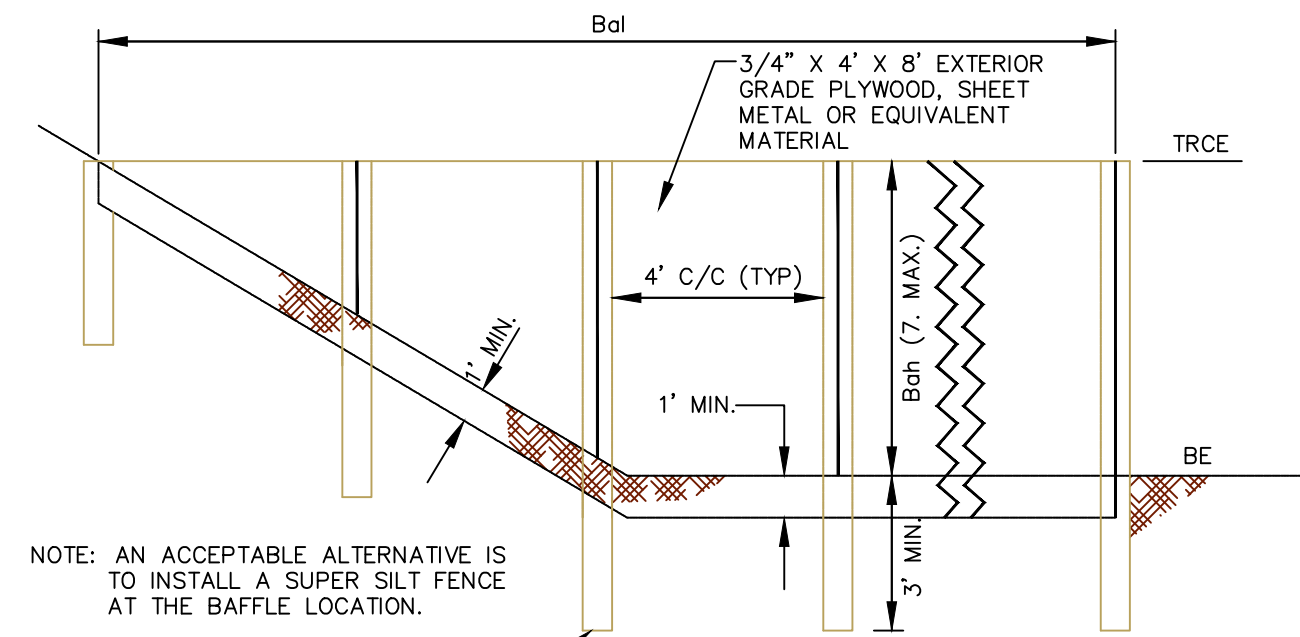

NOTE: AN ACCEPTABLE ALTERNATIVE IS TO INSTALL A SUPER SILT FENCE AT THE BAFFLE LOCATION.

4" X 4" PRESSURE TREATED WOOD POSTS OR EQUIVALENT MATERIAL

IN POOLS WITH DEPTHS EXCEEDING 7', THE TOP OF THE PLYWOOD BAFFLE DOES NOT NEED TO EXTEND TO THE TEMPORARY RISER CREST.

BASIN NO.	BAFFLE		TEMPORARY RISER	BOTTOM
	LENGTH Bal (FT)	HEIGHT Bah (FT)	CREST ELEV TRCE (FT)	BOTTOM ELEV BE (FT)
-	-	-	-	-

SEE APPROPRIATE BASIN DETAIL FOR PROPER LOCATION AND ORIENTATION

BAFFLES MUST BE TIED INTO ONE SIDE OF THE BASIN UNLESS OTHERWISE SHOWN ON THE PLAN DRAWINGS.

SUBSTITUTION OF MATERIALS NOT SPECIFIED IN THIS DETAIL MUST BE APPROVED BY THE DEPARTMENT OR THE LOCAL CONSERVATION DISTRICT BEFORE INSTALLATION.

DAMAGED OR WARPED BAFFLES SHALL BE REPLACED WITHIN 7 DAYS OF INSPECTION.

BAFFLES REQUIRING SUPPORT POSTS SHALL NOT BE INSTALLED IN BASINS REQUIRING IMPERVIOUS LINERS.

2 BAFFLE
10B NOT TO SCALE

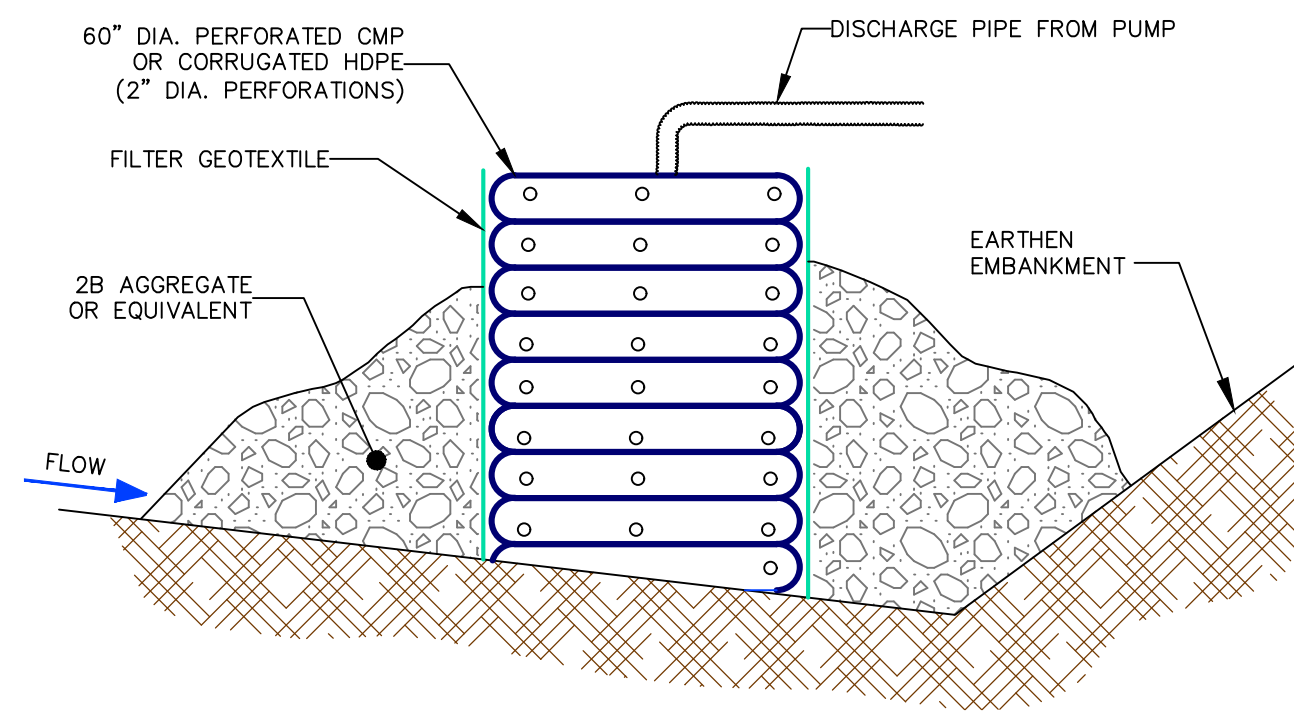

5 TEMPORARY SUMP DETAIL
10B NOT TO SCALE

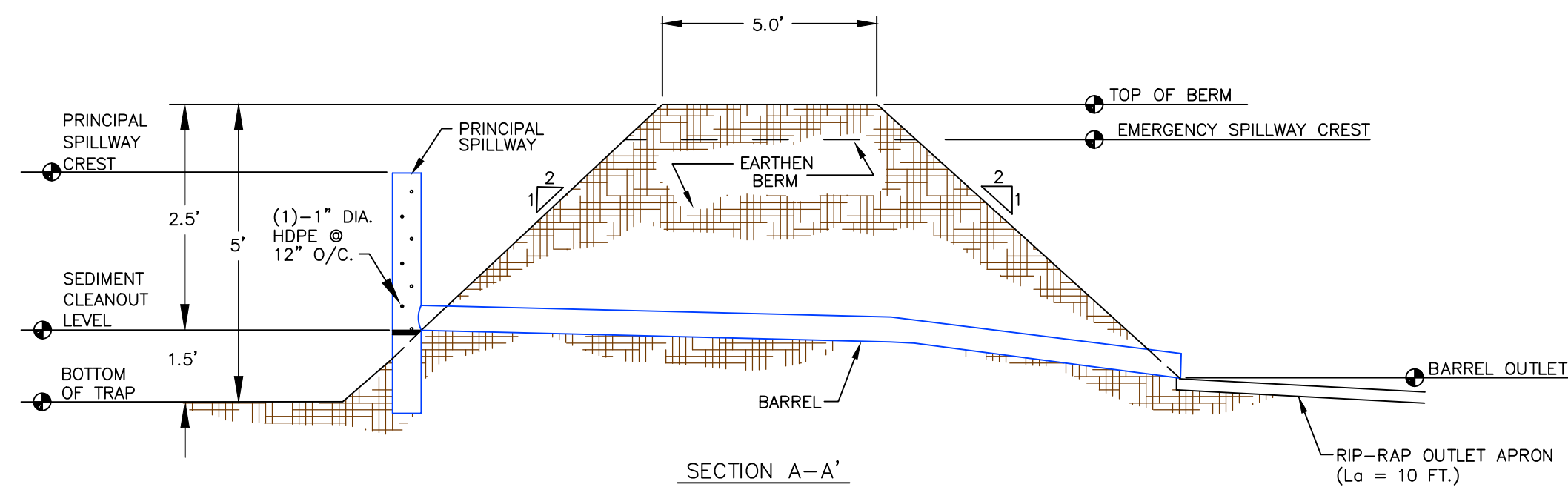

NOTE:
SEDIMENT TRAPS MAY BE USED IN AREAS UP TO 5 ACRES THAT DO NOT DRAIN INTO A SEDIMENT BASIN.

6 TYPICAL SEDIMENT TRAP
10B NOT TO SCALE

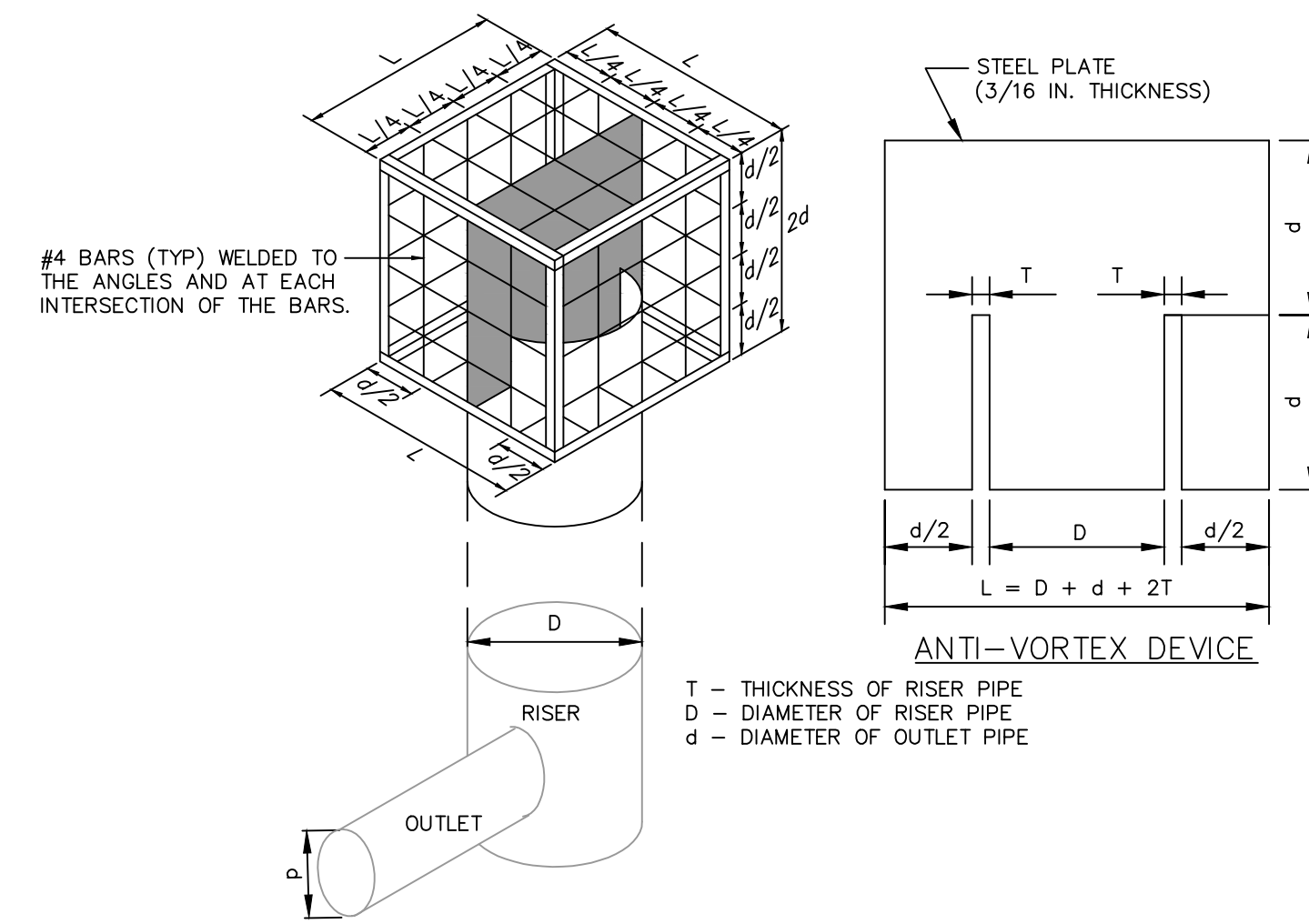
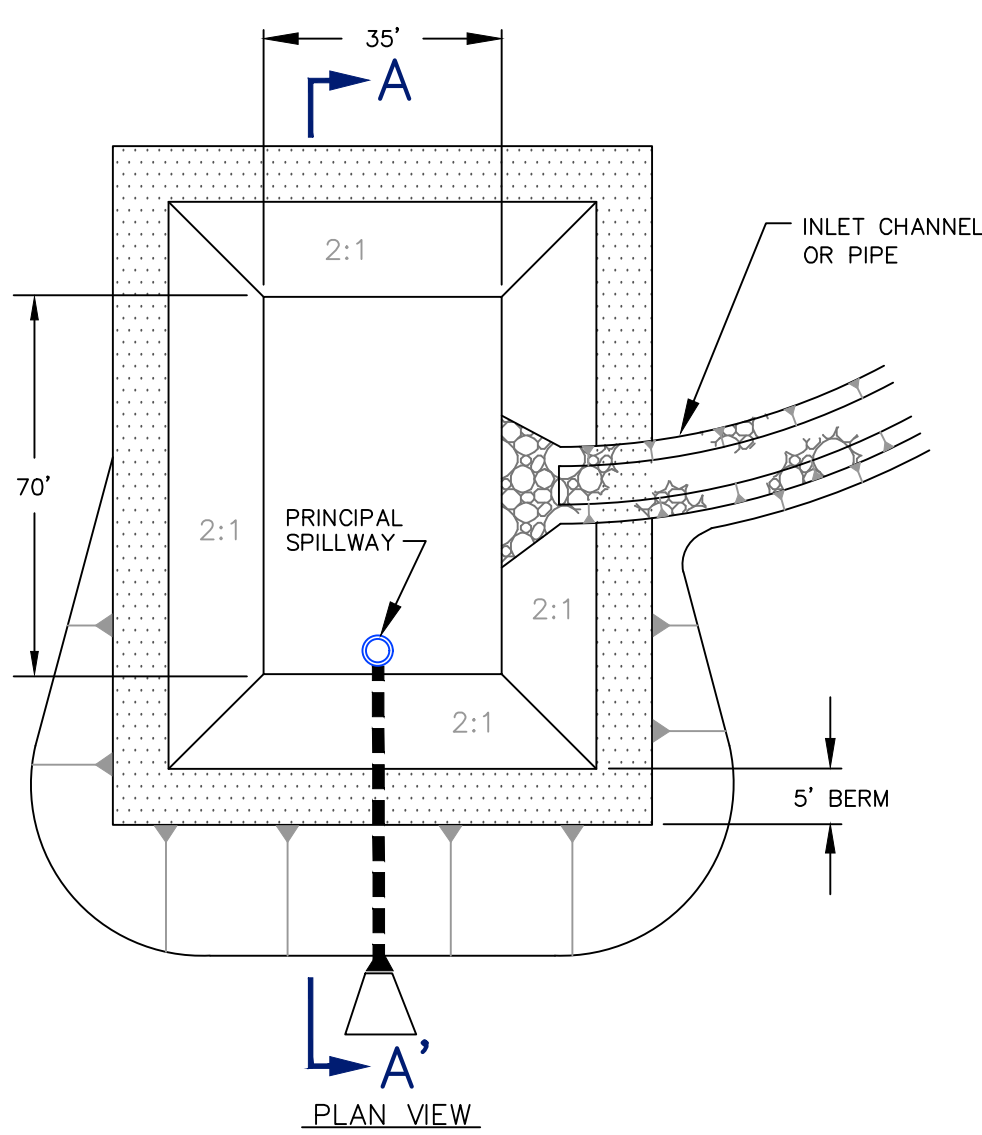

7 STANDARD CONSTRUCTION DETAIL #7-5 TRASH RACK AND ANTI-VORTEX DEVICE
10B NOT TO SCALE

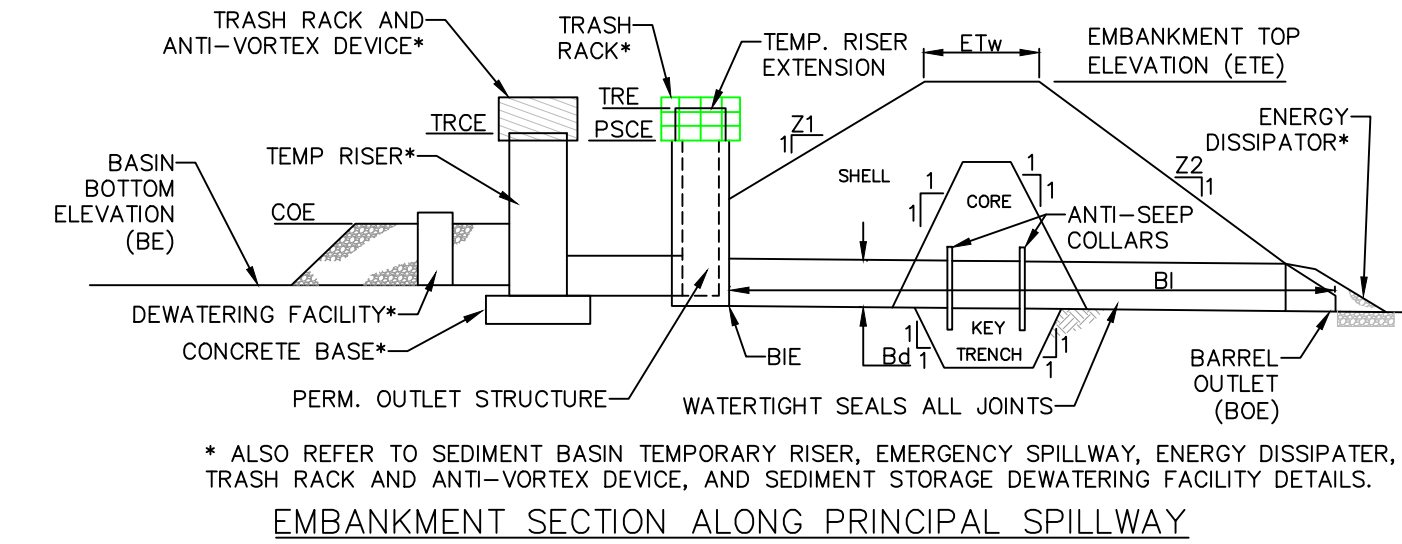

* ALSO REFER TO SEDIMENT BASIN TEMPORARY RISER, EMERGENCY SPILLWAY, ENERGY DISSIPATOR, TRASH RACK AND ANTI-VORTEX DEVICE, AND SEDIMENT STORAGE DEWATERING FACILITY DETAILS.

NOTES:

1. SEDIMENT BASINS, INCLUDING ALL APPURTENANT WORKS, SHALL BE CONSTRUCTED TO THE DETAIL AND DIMENSIONS SHOWN ON THE E&S PLAN DRAWINGS.
2. AREA UNDER EMBANKMENT SHALL BE CLEARED, GRUBBED, AND STRIPPED OF TOPSOIL TO A DEPTH OF TWO FEET PRIOR TO ANY PLACEMENT AND COMPACTION OF EARTHEN FILL. FILL MATERIAL FOR THE EMBANKMENTS SHALL BE FREE OF ROOTS, OR OTHER WOODY VEGETATION, ORGANIC MATERIAL, LARGE STONES, AND OTHER OBJECTIONABLE MATERIALS. THE EMBANKMENT SHALL BE COMPACTED IN LAYERED LIFTS OF NOT MORE THAN 6 TO 8 IN. THE MAXIMUM ROCK SIZE SHALL BE NO GREATER THAN 2/3 THE LIFT THICKNESS. UPON COMPLETION, THE EMBANKMENT SHALL BE SEEDED AND MULCHED OR OTHERWISE STABILIZED ACCORDING TO THE SPECIFICATIONS OF THE E&S PLAN DRAWINGS. TREES SHALL NOT BE PLANTED ON THE EMBANKMENT.
3. ALL SEDIMENT BASINS SHALL BE INSPECTED ON AT LEAST A WEEKLY BASIS AND AFTER EACH RUNOFF EVENT.
4. ACCESS FOR SEDIMENT REMOVAL AND OTHER REQUIRED MAINTENANCE ACTIVITIES SHALL BE PROVIDED.
5. A CLEAN OUT STAKE SHALL BE PLACED NEAR THE CENTER OF EACH BASIN. ACCUMULATED SEDIMENT SHALL BE REMOVED WHEN IT HAS REACHED THE CLEAN OUT ELEVATION ON THE STAKE AND THE BASIN RESTORED TO ITS ORIGINAL DIMENSIONS. DISPOSE OF MATERIALS REMOVED FROM THE BASIN IN THE MANNER DESCRIBED IN THE E&S PLAN.
6. BASIN EMBANKMENTS, SPILLWAYS, AND OUTLETS SHALL BE CHECKED FOR EROSION, PIPING AND SETTLEMENT. NECESSARY REPAIRS SHALL BE MADE IMMEDIATELY. DISPLACED RIPRAP WITHIN THE OUTLET ENERGY DISSIPATOR SHALL BE REPLACED IMMEDIATELY. ACCUMULATED SEDIMENT SHALL BE REMOVED AND DISTURBED AREAS INSIDE THE BASIN STABILIZED BEFORE CONVERSION TO A STORMWATER MANAGEMENT FACILITY. THE DEVICE SHOWN IN STANDARD CONSTRUCTION DETAIL #7-16 MAY BE USED TO DEWATER SATURATED SEDIMENT PRIOR TO ITS REMOVAL. ROCK FILTERS SHALL BE ADDED AS NECESSARY.
7. EXISTING BASINS WERE EITHER SIZED OR SLIGHTLY MODIFIED FOR USE DURING THIS EXPANSION. THE KEY TRENCH DETAILS OF THE EXISTING BASINS ARE UNKNOWN.

3 STANDARD CONSTRUCTION DETAIL #7-8 SEDIMENT BASIN DETENTION POND EMBANKMENT AND SPILLWAY DETAILS
10B NOT TO SCALE

BASIN SUMMARY

BASIN NUMBER	Z1	Z2	DIA TRD (in)	CREST ELEV TRCE (ft.)	MAT'L	DIA BD (in.)	INLET ELEV BIE (ft.)	MAT'L	LENGTH Bl (ft.)	OUTLET ELEV BOE (ft.)	TOP ELEV ETE (ft.)	TOP WIDTH ETW (ft.)	KEY TRENCH DEPTH (ft.)	KEY TRENCH WIDTH (ft.)	CLEANOUT ELEV COE (ft.)	BOTTOM ELEV BE (ft.)
2(PHASE 1)	3	2	36	446.50	CMP	30	441.50	CMP	86	430.00	450.00	8	SEE NOTE 7		441.50	436.00
2(PHASE 2)	3	2	36	446.50	CMP	30	441.50	CMP	86	430.00	450.00	8	SEE NOTE 7		441.50	436.00
3	3	2	36	450.00	CMP	30	443.50	CMP	125	440.00	454.00	10	SEE NOTE 7		443.50	440.00
5	3	3	30	730.00	CMP	24	720.00	CMP	200	720.00	735.00	10	SEE NOTE 7		722.50	720.00
6	3	3	36	674.84	CMP	24	668.00	CMP	270	662.00	680.00	10	SEE NOTE 7		668.00	662.00
7	3	3	39	556.00	CMP	36	548.50	CMP	73	543.00	560.00	10	SEE NOTE 7		548.50	546.00
8	2	3	30	686.50	CMP	24	682.00	CMP	110	680.00	690.00	8	SEE NOTE 7		682.00	680.00

EROSION & SEDIMENTATION NOTES

1. SEDIMENTATION BASINS ARE DESIGNED TO STORE, AT A MINIMUM, 3,600 CU FT. RUNOFF PER TOTAL TRIBUTARY ACRE AND 1,000 CU FT SEDIMENT PER DISTURBED TRIBUTARY ACRE.
2. DURING BASIN CONSTRUCTION, CONSTRUCT AND MAINTAIN A TEMPORARY SUMP AT THE UPSTREAM TOE OF THE BASIN DAM. PUMP RUNOFF PONDED IN THE TEMPORARY SUMP THROUGH A SEDIMENT FILTER BAG TO A STABILIZED OUTLET, OR INTO A STRAW BALE FILTER TRAP AS SHOWN ON SHEET 10D.
3. DURING BASIN CONSTRUCTION, USE BEST MANAGEMENT PRACTICES WHERE EMBANKMENTS OR OTHER PROTECTION AREAS DO NOT OTHERWISE DRAIN TO A SEDIMENT CONTROL DEVICE. INSTALLATION AND MAINTENANCE OF SILT FENCE AND/OR STRAW BALES WILL COMPLY WITH THE DETAILS SHOWN ON SHEET 10D.
4. THE ELEVATION OF THE BOTTOM ROW OF PERFORATIONS IS IDENTICAL TO THE SEDIMENT CLEAN-OUT ELEVATION.
5. SEDIMENT SHALL BE REMOVED FROM SEDIMENTATION BASINS WHEN SEDIMENT HAS ACCUMULATED TO THE CLEAN-OUT ELEVATION AS MARKED ON THE PRINCIPAL SPILLWAY RISER OR CLEANOUT STAKE.
6. REFER TO SHEET 10B THROUGH 10D FOR EROSION AND SEDIMENTATION CONTROL DETAILS.
7. BASINS HAVE A MINIMUM 8 FEET BERM TOP WIDTH.
8. THE EXACT LOCATION OF PROPOSED EROSION AND SEDIMENTATION CONTROLS (CHANNELS AND DITCHES, ETC.) MAY DIFFER FROM THE PLANS DUE TO FIELD ENGINEERING AND ADJUSTMENTS; HOWEVER, THEIR FUNCTION AND DESIGN WILL NOT DEVIATE FROM THAT PERMIT.

	REVISIONS	
	DATE:	09/25/17
DELAWARE COUNTY SOLID WASTE AUTHORITY ROLLING HILLS LANDFILL SOUTHERN AREA LANDFILL EXPANSION	DRAWN BY:	SWH
EARL TOWNSHIP BERKS COUNTY PENNSYLVANIA STORMWATER MANAGEMENT SEDIMENTATION Basin, Trap Schedules and Details	CHECKED:	KCC
State College Office (814) 238-2060	BAI DRAWING NO: DCSWA-107D018B	SHEET NO. 10B OF 11

