

- REFERENCES:
- EXISTING TOPOGRAPHY OF BIG SEWICKLEY CREEK, IN THE VICINITY OF THE WITHDRAWAL LOCATION, OBTAINED FROM FIELD SURVEY PERFORMED BY CIVIL & ENVIRONMENTAL CONSULTANTS, INC. (CEC) IN JULY 2024. FORMER TOPOGRAPHY OF THE SAME AREA WAS OBTAINED FROM FIELD SURVEY PERFORMED BY CIVIL & ENVIRONMENTAL CONSULTANTS, INC. (CEC) IN JANUARY 2023. EXISTING CONTOURS OUTSIDE OF THESE AREAS DERIVED FROM THE PAMAP PROGRAM 3.2 FT DIGITAL ELEVATION MODEL OF PENNSYLVANIA; DEVELOPED BY PAMAP PROGRAM, PA DEPARTMENT OF CONSERVATION AND NATURAL RESOURCES, BUREAU OF TOPOGRAPHIC AND GEOLOGIC SURVEY; DATED MAY 2006.
 - STREAM AND WETLAND DELINEATION COMPLETED BY CEC, INC. IN AUGUST 2020 AND MAY/JUNE 2021.
 - PROPERTY LINES DERIVED FROM BEAVER COUNTY TAX PARCEL DATA AND SUPPLEMENTED BY FIELD SURVEY PERFORMED BY CEC, INC. IN NOVEMBER & DECEMBER 2020 AND JUNE 2021.
 - SOURCES, INCLUDING THE PENNSYLVANIA DEPARTMENT OF TRANSPORTATION TYPE 5B MAPS FOR ECONOMY BOROUGH AND BELL ACRES BOROUGH, INDICATE THAT THE MUNICIPAL BOUNDARY FOLLOWS THE CENTERLINE OF BIG SEWICKLEY CREEK. THE MUNICIPAL BOUNDARY SHOWN ON THE PLANS WAS DIGITIZED BASED ON THE EXISTING STREAM LOCATION.

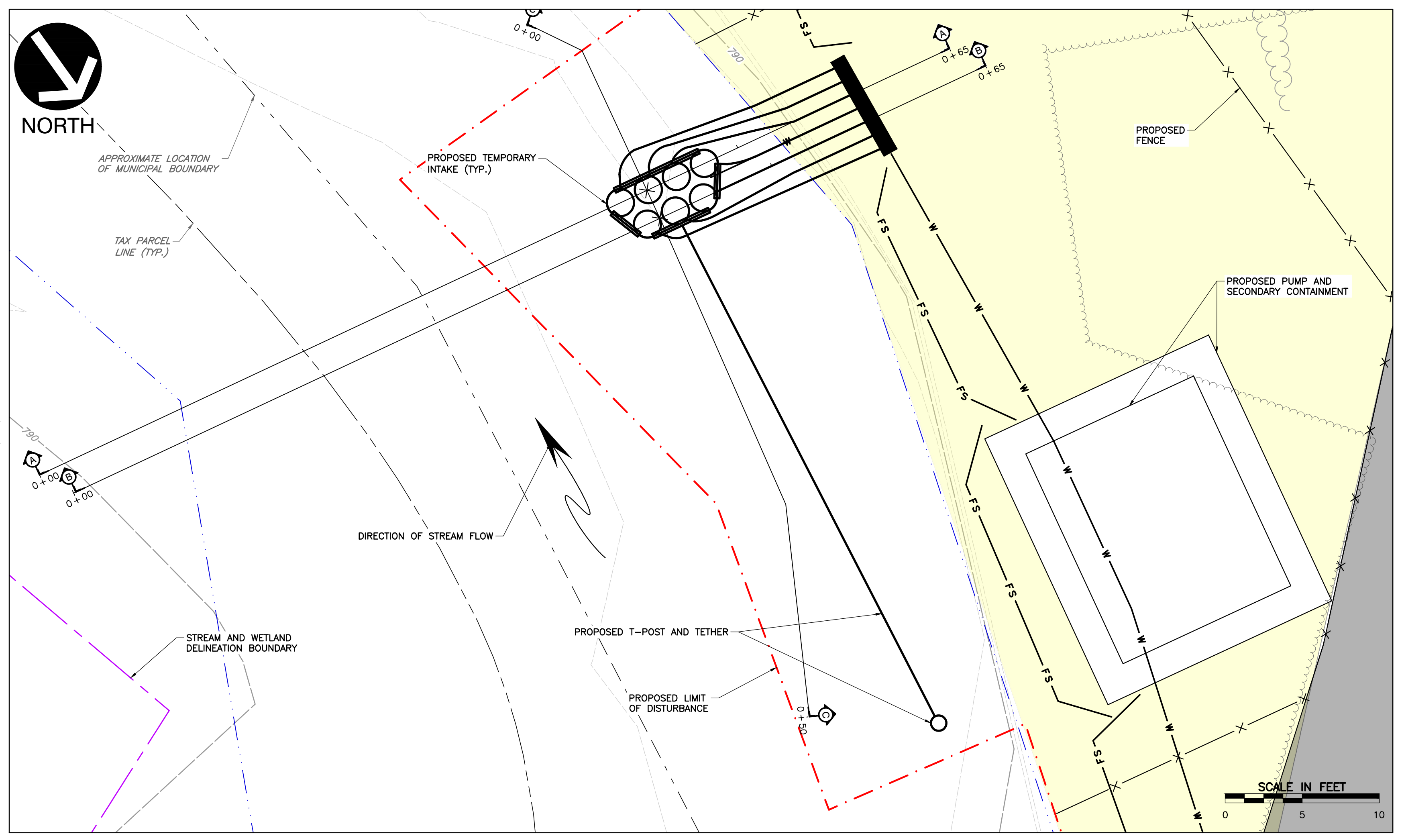
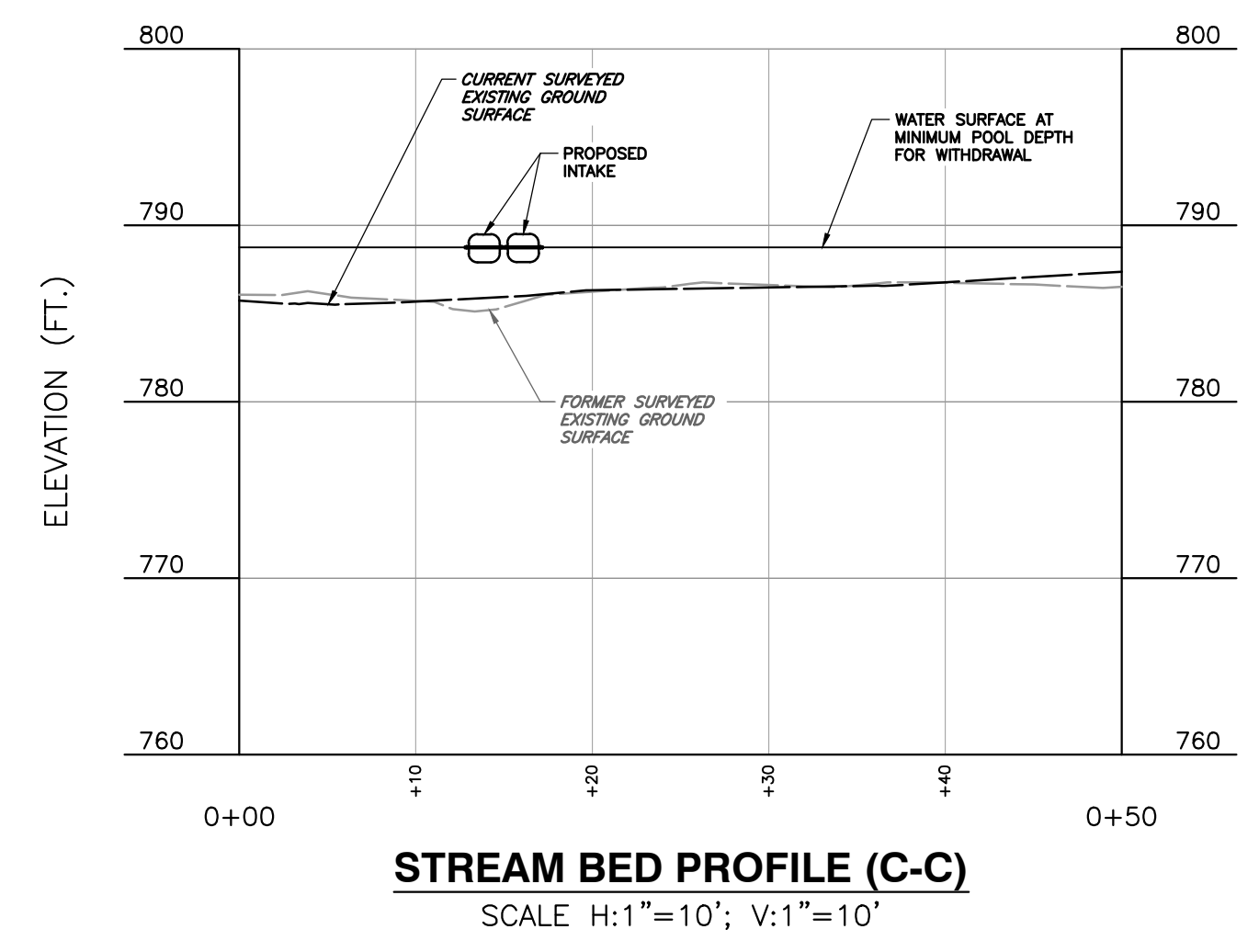

DETAIL 1
PROPOSED TEMPORARY INTAKE
(BIG SEWICKLEY CREEK)

LEGEND	
-1200-	EXISTING INDEX CONTOUR
-600-	EXISTING INTERMEDIATE CONTOUR
---	EXISTING PAVED ROAD
---	EXISTING UNPAVED ROAD
---	TAX PARCEL LINE
---	PROPERTY LINE BASED ON FIELD EVIDENCE
---	STREAM/WETLAND DELINEATION BOUNDARY
---	EXISTING STREAM
---	ASSUMED 50' FLOODWAY
---	FEMA FLOODWAY
---	EXISTING OVERHEAD WIRE/UTILITY POLE
---	EXISTING FENCE
---	EXISTING GAS PIPELINE/MARKER
---	EXISTING TREELINE
---	EXISTING SANITARY SEWER/MANHOLE
---	EXISTING SIGN
---	EXISTING WATERLINE
---	EXISTING CHANNEL
---	EXISTING CULVERT/STORM PIPE/INLET
---	PROPOSED TEMPORARY ABOVE GROUND WATERLINE
---	AREA NOT TO BE DISTURBED
---	PROPOSED LIMIT OF DISTURBANCE
---	PROPOSED FILTER SOCK
---	PROPOSED ORANGE CONSTRUCTION FENCE
---	PROPOSED TIMBER MAT
---	PROPOSED ROCK CONSTRUCTION ENTRANCE
---	PROPOSED ROCK STOCKPILE
---	PROPOSED PERMANENT WATERBAR
---	PROPOSED TEMPORARY WATERBAR
---	PROPOSED RIPRAP APRON
---	PROPOSED SLOPE STABILIZATION

REVISION RECORD		
NO.	DATE	DESCRIPTION

PENNENERGY
RESOURCES

CEC
Civil & Environmental Consultants, Inc.
700 Cherrington Parkway · Moon Township, PA 15108
412-429-2324 · 800-365-2324
www.cecinc.com

PENNENERGY RESOURCES, LLC
B50 TEMPORARY
ABOVE-GROUND WATERLINE
ECONOMY BOROUGH
BEAVER COUNTY, PA

STREAM SURVEY EXHIBIT

DATE: MARCH 2022 DRAWN BY: JTD
DWG SCALE: AS SHOWN CHECKED BY: VJS
PROJECT NO: 317-457
APPROVED BY: DRAFT

DRAWING NO.: **JP03**

P:\310-000\317-457-CADD\DWG\CIVIL\01\317-457-CR1-CP-FIGURES_UPDATED.dwg [PLOT] LS(8/15/2024 3:17 PM) - LP: 8/15/2024 3:17 PM