

Wednesday, January 3, 2018 5:00:04 PM

R:\2015\152596 - SGI Disposal Embankment Drawings Northern Tract\Exhibit 12-Texas Crossing 1-R0.dwg

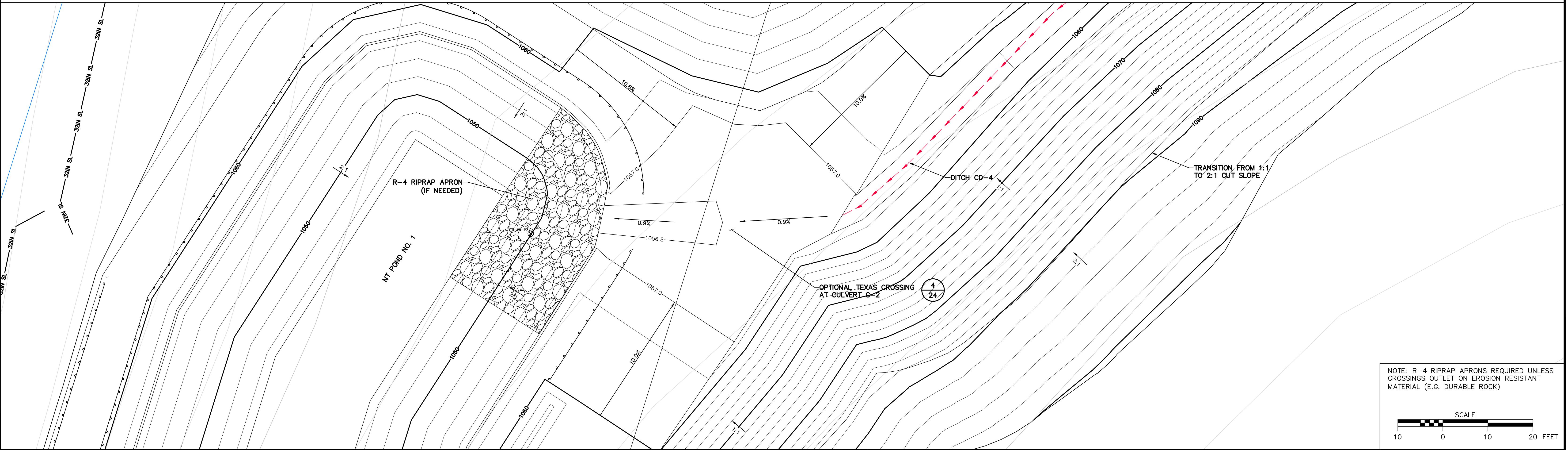

NOTE: R-4 RIPRAP APRONS REQUIRED UNLESS CROSSINGS OUTLET ON EROSION RESISTANT MATERIAL (E.G. DURABLE ROCK)

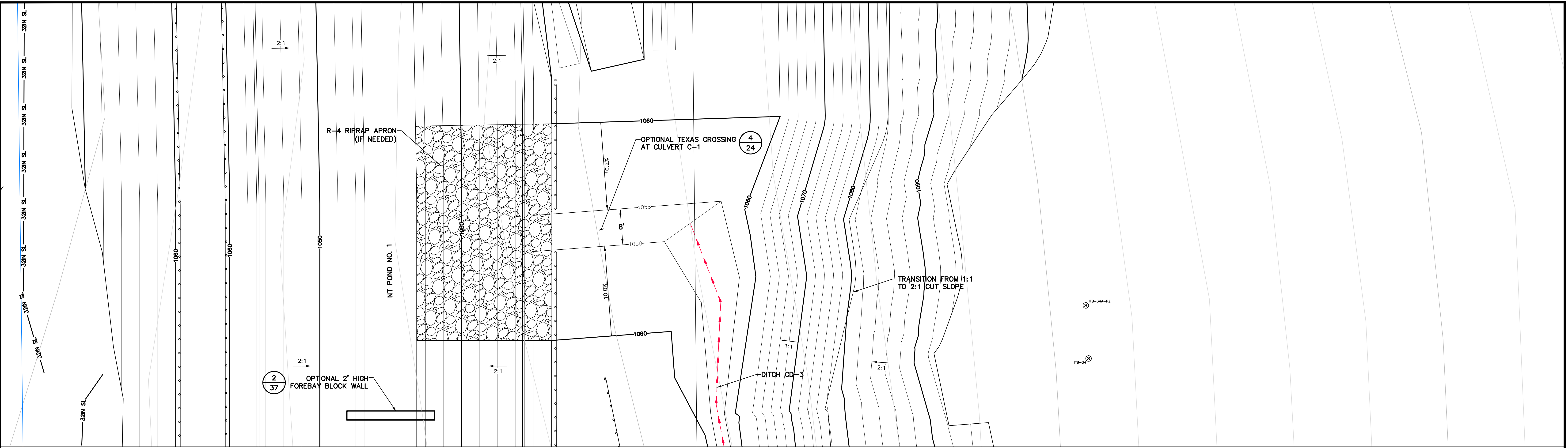
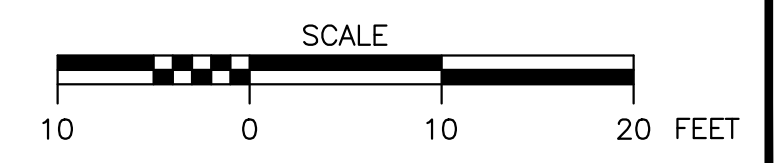

NOTES / REVISIONS			
ISSUED FOR	DATE	REV.	REVISION DESCRIPTION
		1	
		2	
		3	
		4	
		5	
		6	
		7	
		8	
		9	
		10	
		11	
		12	
		13	
		14	
		15	
		16	
		17	
		18	
		19	
		20	
		21	
		22	
		23	
		24	
		25	
		26	
		27	
		28	
		29	
		30	
		31	
		32	
		33	
		34	
		35	
		36	
		37	
		38	
		39	
		40	
		41	
		42	
		43	
		44	
		45	
		46	
		47	
		48	
		49	
		50	
		51	
		52	
		53	
		54	
		55	
		56	
		57	
		58	
		59	
		60	
		61	
		62	
		63	
		64	
		65	
		66	
		67	
		68	
		69	
		70	
		71	
		72	
		73	
		74	
		75	
		76	
		77	
		78	
		79	
		80	
		81	
		82	
		83	
		84	
		85	
		86	
		87	
		88	
		89	
		90	
		91	
		92	
		93	
		94	
		95	
		96	
		97	
		98	
		99	
		100	

SEAL:

ROBERT M. SHUSKO
REGISTERED PROFESSIONAL ENGINEER
107023-E
12-22-17

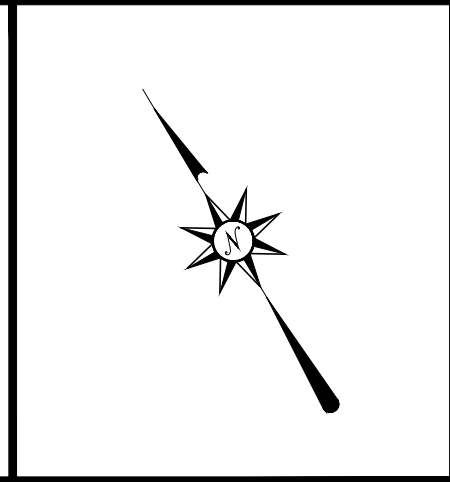

D'APPOLONIA
701 RODI ROAD, FLOOR 2
PITTSBURGH, PENNSYLVANIA 15235-4559
(412) 856-9440 FAX (412) 856-9535

SKELLY AND LOY
ENGINEERING - ENVIRONMENTAL CONSULTANTS

PROJECT NUMBER: 152596A
FILE NAME: Exhibit 12-Texas Crossing 1-R0.dwg

DRAWN BY: WRO
CHECKED BY: RMS/MDW

DATE: 10/24/2016
DATE: 12/22/2017

SPECIALTY GRANULES LLC
CHARMIAN - NORTHERN TRACT QUARRY

EXHIBIT 12
OPTIONAL TEXAS CROSSINGS

SCALE: AS SHOWN
DRAWING NO. 26
REV 0