

NOTES:

1. MONITORING WELL MW-13D TO BE ABANDONED AND REPLACED WITH MW-13R DURING PHASE 2 OF THE INITIAL SITE DEVELOPMENT.
2. MONITORING WELL MW-9S AND MW-9D TO BE ABANDONED AND REPLACED WITH MW-9SR AND MW-9DR DURING PHASE 3 OF THE INITIAL SITE DEVELOPMENT.
3. FOR THE PROPOSED MONITORING LOCATIONS ON PRIVATE PROPERTY, UPON PADEP APPROVAL OF THE MONITORING PROGRAM, SGI WILL PROCEED WITH OBTAINING PERMISSION FOR LONG-TERM ACCESS FROM THE PROPERTY OWNERS.

SAMPLE ID	BACKGROUND	MONITORING
PWS-07A16	X	
PWS-16A16	X	
PWS-95BB16	X	
SS-TC US	X	X
SS-TC DS	X	X
SS-CHN1 US	X	X
SS-CHN1 DS	X	X
SS-UPPER SEEP	X	X
SS-LOWER SEEP	X	
SS-PFO WETLAND	X	
SS-DCNR Seep 1	X	X
SS-DCNR Seep 2	X	
W-POND 1	X	X
W-WETLAND C	X	X
W-WETLAND D	X	
SS-DCNR CHN	X	
MW-8S	X	
MW-8D	X	X
MW-9S	X	
MW-9D	X	X
MW-10D	X	X
MW-11D	X	X
MW-12D	X	
MW-13D	X	X
MW-14S	X	
MW-14D	X	X
PWS-15A16	X	X
SS-4	X	X

LEGEND

- 1200 ——— EXISTING TOPOGRAPHIC MAJOR CONTOUR (25' CONTOUR INTERVAL)
 - EXISTING TOPOGRAPHIC MINOR CONTOUR (5' CONTOUR INTERVAL)
 - PROPERTY BOUNDARY
 - - - - - EXISTING PERMIT BOUNDARY
 - PROPOSED PERMIT BOUNDARY
 - PROPOSED 1000' PERMIT BOUNDARY OFFSET
 - ===== EXISTING ROAD
 - GAS — GAS — EXISTING GAS LINE
 - ←←←← LOCAL GROUNDWATER FLOW DIRECTION
 - ←←←← REGIONAL GROUNDWATER FLOW DIRECTION
 - 300' DWELLING BARRIER
 - WATERS OF THE UNITED STATES
 - STREAM
 - WETLANDS (DELINEATED BY SKELLY & LOY 12/16/2015)
 - WETLANDS (DELINEATED BY AECOM 1/2011 AND 5/2012)
 - OCCUPIED STRUCTURE
 - UNOCCUPIED STRUCTURE
 - SOIL BORINGS
 - ROCK BORINGS
 - MONITORING WELL OR PIEZOMETER
 - EXISTING PRIVATE WATER SUPPLY WELL
- WATER SAMPLING LOCATION LEGEND**
- MW-13D BACKGROUND GROUND WATER MONITORING STATION FOR NORTHERN TRACT QUARRY (MONITORING WELL)
 - MW-11D BACKGROUND AND PROPOSED LONG TERM GROUND WATER MONITORING STATION FOR NORTHERN TRACT QUARRY (MONITORING WELL)
 - SS-13 EXISTING STREAM SAMPLE LOCATION
 - SP-3 EXISTING SPRING/SEEP LOCATION
 - 001 NPDES DISCHARGE LOCATION
 - BACKGROUND SURFACE WATER MONITORING STATION FOR NORTHERN TRACT QUARRY
 - BACKGROUND AND LONG TERM SURFACE WATER MONITORING STATION FOR NORTHERN TRACT QUARRY
 - 07A16 BACKGROUND GROUND WATER MONITORING STATION FOR NORTHERN TRACT QUARRY (EXISTING PRIVATE WATER SUPPLY WELL)
 - 15A16 BACKGROUND AND PROPOSED LONG TERM GROUND WATER MONITORING STATION FOR NORTHERN TRACT QUARRY (EXISTING PRIVATE WATER SUPPLY WELL)
- GEOLOGY LEGEND**
- SECTION DESIGNATION
 - REFERENCE DRAWING NUMBER
 - HAARPERS FORMATION
 - GREENSTONE SCHIST
 - WEVERTON AND LOUDOUN FORMATION, UNDIVIDED
 - METABASALT
 - METARHYOLITE
 - FAULT (TEETH ON UPTHROWN BLOCK)
- STRIKE AND DIP SYMBOL LEGEND**
- REGIONAL AXIAL-PLANE CLEAVAGE (S1)
 - INCLINED STRIKE AND DIP OF BEDDING IN SEDIMENTARY ROCKS (S0)
 - INTERSECTION OF REGIONAL AXIAL-PLANE CLEAVAGE WITH DOMINANT SLIP (CRENULATION) CLEAVAGE (L1x2)
 - OVERTURNED STRIKE AND DIP OF LAYERING OR FLOW (?) BANDING IN VOLCANIC ROCKS (S0)
 - INCLINED STRIKE AND DIP OF LAYERING OR FLOW (?) BANDING IN VOLCANIC ROCKS (S0)
 - MULTIPLE JOINT SYSTEM STRIKE AND DIP OF SYSTEMATIC JOINT IN THE CATOCTIN FORMATION (J5)
 - OVERTURNED STRIKE AND DIP OF BEDDING IN SEDIMENTARY ROCKS (S0)
 - SUBORDINATE SLIP OR CRENULATION CLEAVAGE (S2') STRIKE AND DIP CLEAVAGE
 - MINERAL LINATION IN THE PLANE OF REGIONAL AXIAL-PLANE CLEAVAGE (L0)
- SOURCE: FAULT: JOHN L., 1978 GEOLOGIC MAP OF THE IRON SPRINGS AND BLUE RIDGE SUMMIT QUADRANGLES, ADAMS AND FRANKLIN COUNTIES, PENNSYLVANIA

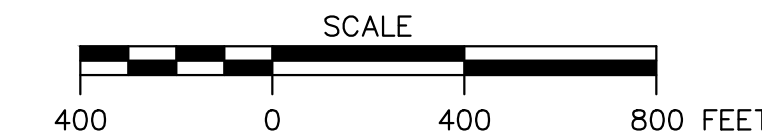
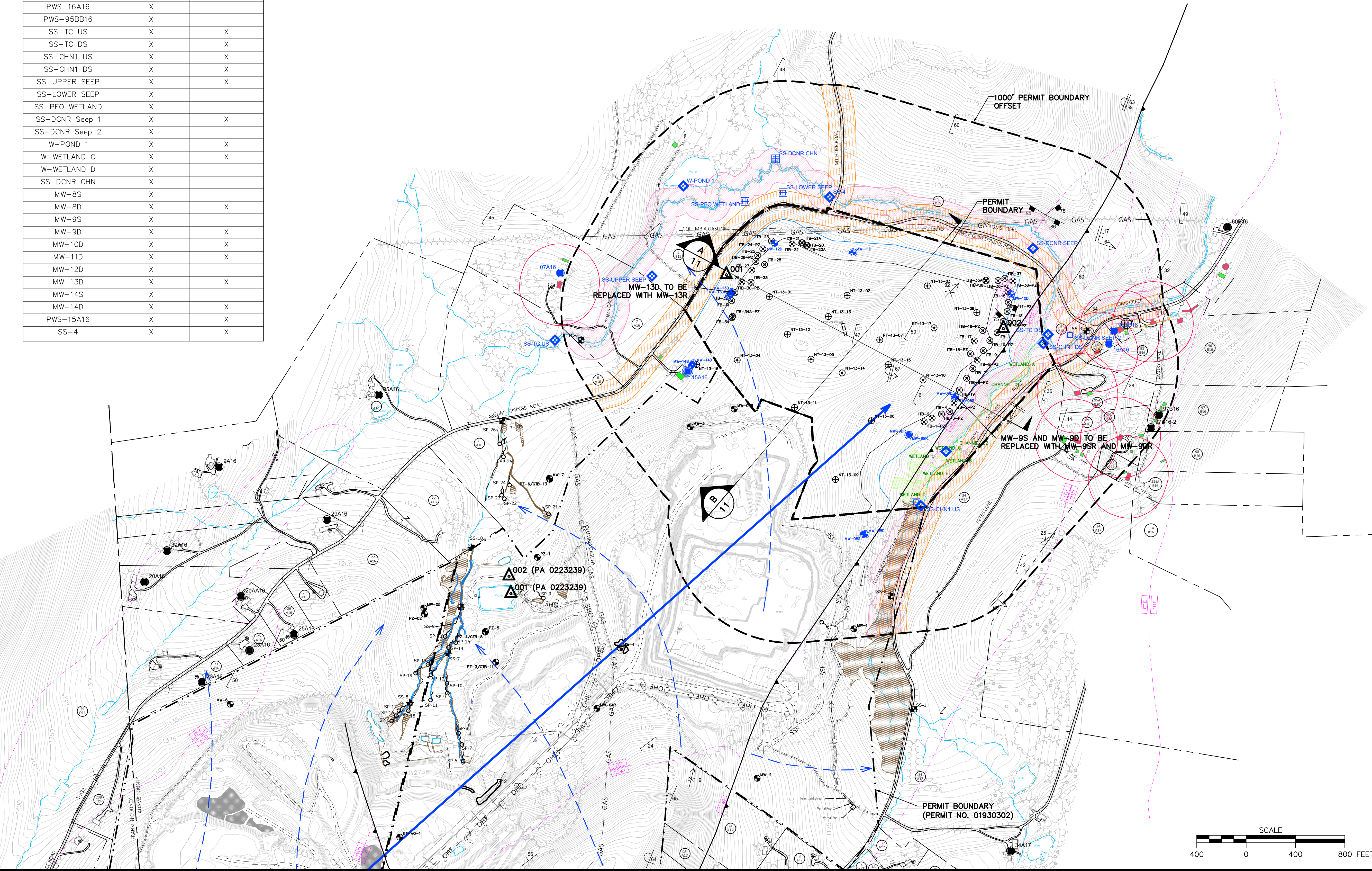

NOTES / REVISIONS

NO.	DATE	REVISION DESCRIPTION	MADE BY	CHKD BY	DATE
1	4/17/2018	REVISED PER PADEP-DMO COMMENT LETTER DATED 3/6/2018	MJD	MDW	4/17/2018

SEAL: COMMONWEALTH OF PENNSYLVANIA REGISTERED PROFESSIONAL GEOLOGIST DOUGLAS JAY HESS No. P00001880

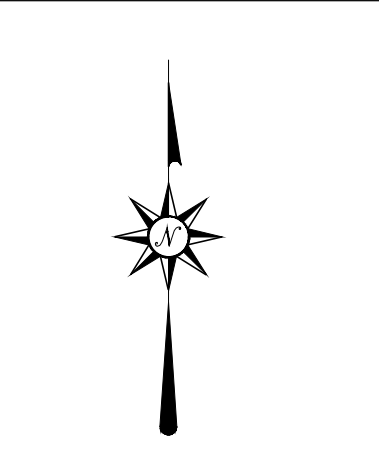

D'APPOLONIA
101 RODI ROAD, FLOOR 2
PITTSBURGH, PENNSYLVANIA 15225-4559
(412) 856-9440 FAX (412) 856-9535

SKELLY AND LOY
ENGINEERING - ENVIRONMENTAL CONSULTANTS

SGI

PROJECT NUMBER: 152596A
FILE NAME: Exhibit 6.2-R1.dwg

DRAWN BY: AJM
CHECKED BY: RMS/MDW

DATE: 4/16/2018
DATE: 12/22/2017

SPECIALTY GRANULES LLC
CHARMIAN - NORTHERN TRACT QUARRY

EXHIBIT 6.2
ENVIRONMENTAL RESOURCES MAP

SCALE: AS SHOWN
DRAWING NO. 5
REV 1

Monday, April 16, 2018 10:24:37 AM R: 2015152596 - SGI Disposal Embankment Drawings Northern Tract Exhibit 6.2-R1.dwg