



**pennsylvania**

DEPARTMENT OF ENVIRONMENTAL PROTECTION

Active and Abandoned Mine Operations



# New Hope Crushed Stone

Quarry Views

Solebury Communications Group

June 30, 2018

Tom Wolf, Governor

Patrick McDonnell, Secretary

# June 30, 2018 Project Status

|                             |   |             |
|-----------------------------|---|-------------|
| STATUS AS OF:               | June 30, 2018   |             |
| PROJECT                     | New Hope Crushed Stone (NHCS) Quarry Reclamation and Stream Restoration |             |
| START DATE                  | Reclamation: January 29, 2016<br>Stream Restoration: January 29, 2016   |             |
| ANTICIPATED COMPLETION DATE | Reclamation: March 2019<br>Stream Restoration: March 2019               |             |
| CURRENT STATUS              | Quarry Reclamation  | On Schedule |
|                             | Stream Restoration  | On Schedule |

# June 30, 2018, Quarry Visit

- DEP staff visited the quarry for an overview of the reclamation and stream restoration work.
- The pictures on the following pages show current conditions.
- The new transformer has been received and a pad has been established high above the existing transformer. The milestone for completion is July 31.
- NHCS has been building cribs for placement along the stream banks.
- Reclamation work on the north wall was observed in the area of 10/11 shown on the following map.
- Stone was being loaded along the east wall.
- Increased pumping continues to maintain the two bench safety level, but no lower than -40 mean sea level. Pumping at this rate is expected to continue until the fall.

# Reclamation Progress Location Map

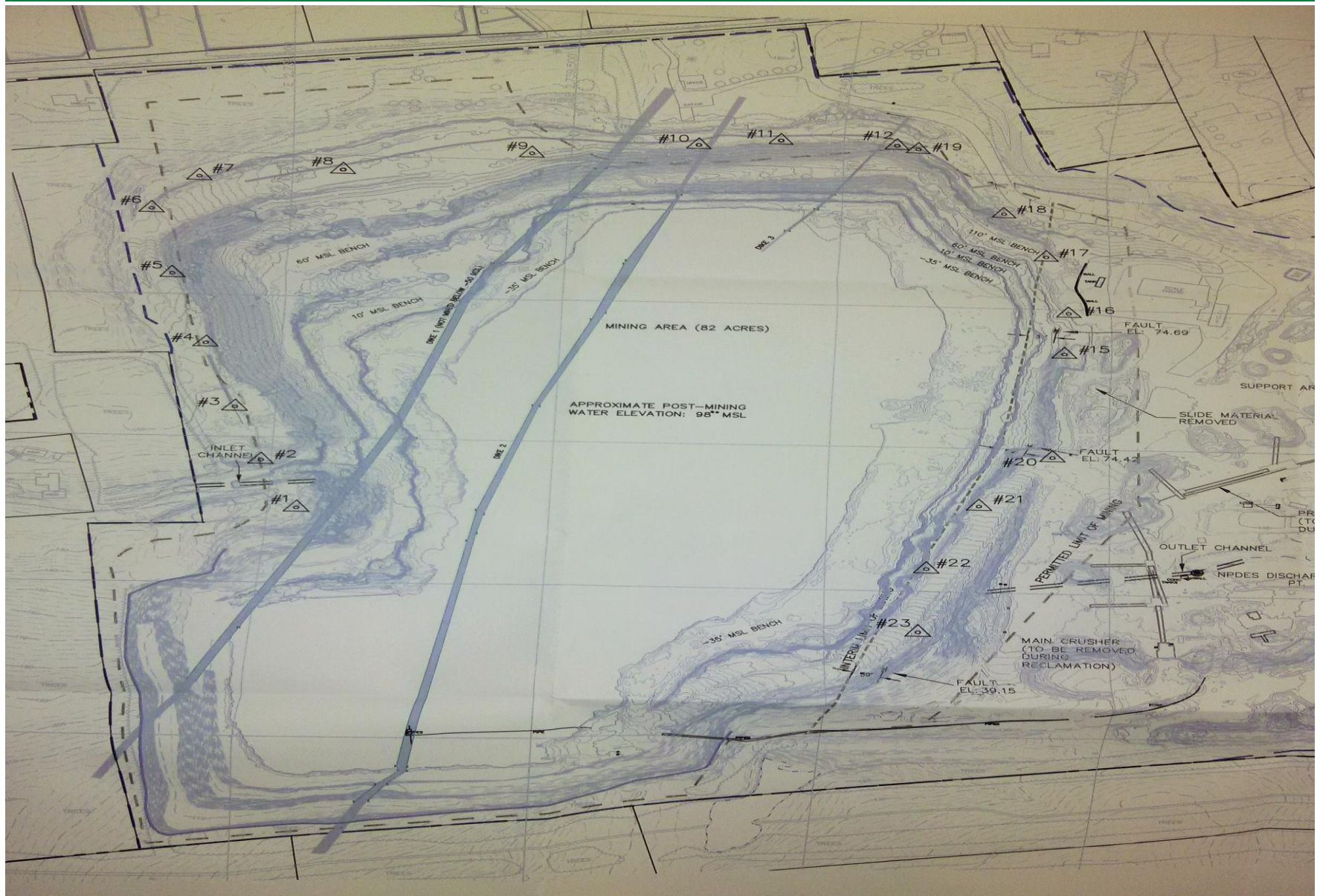



# Transformer Relocation

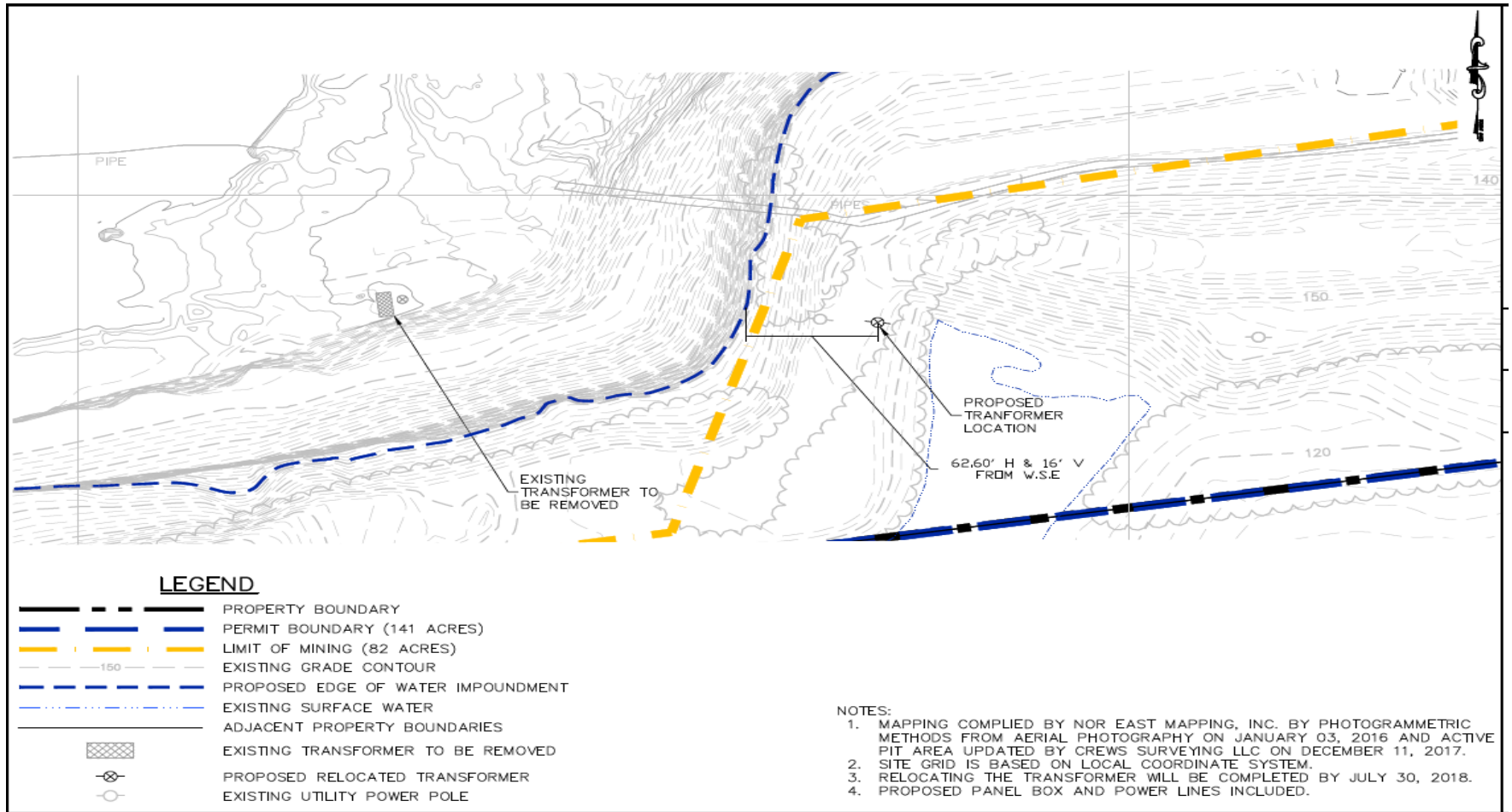

# Transformer Status

Current



New Location

Approximate new location.

Current location.



The new transformer has been received, but not yet placed. The pad can be seen in the center of the picture to the right.





# West Wall





# West Wall, Water Entering Quarry





# North Wall





# East Wall





# Mining Work – East Wall





# Stream Inlet



Heavy rains have eroded the inlet. This will be addressed as part of ongoing stream work as conditions allow.



# Stream Views



Looking east towards quarry.



West towards Solebury School.



# Stream Views



View back east towards Mehok residence and then west towards Solebury School.



Fish are present.





**pennsylvania**

DEPARTMENT OF ENVIRONMENTAL PROTECTION

Active and Abandoned Mine Operations



# For More Information

Monthly Updates, Inspection Reports,  
Communications and more, posted as available.

Please visit: [www.dep.pa.gov](http://www.dep.pa.gov)

Regional Resources > Southeast Region > Community Information

Tom Wolf, Governor

Patrick McDonnell, Secretary