

LOCATION MAP

U.S.G.S. 7 1/2 MINUTE QUADRANGLE: SMITHTON, PA

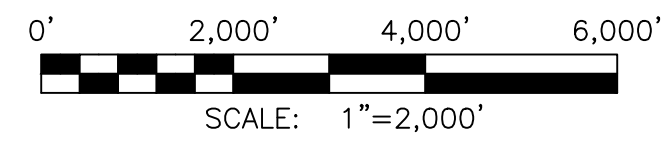

SCALE: 1"=2,000'

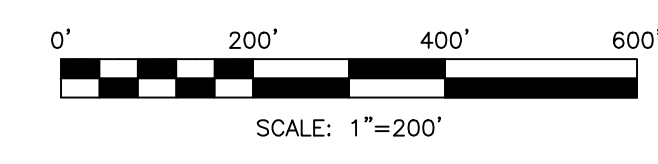
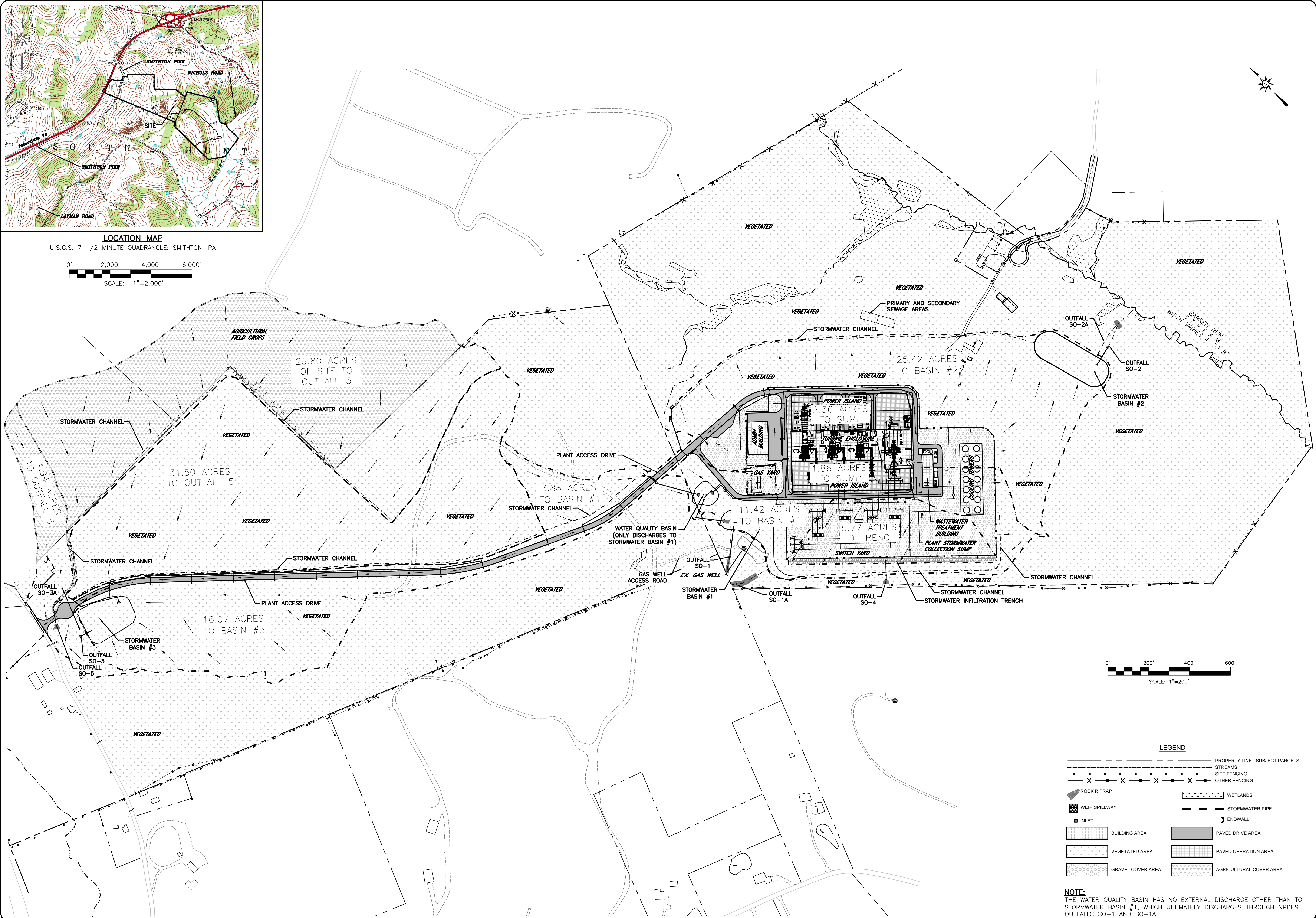

LEGEND

	PROPERTY LINE - SUBJECT PARCELS
	STREAMS
	SITE FENCING
	OTHER FENCING
	ROCK RIPRAP
	WEIR SPILLWAY
	INLET
	BUILDING AREA
	VEGETATED AREA
	GRAVEL COVER AREA
	WETLANDS
	STORMWATER PIPE
	ENDWALL
	PAVED DRIVE AREA
	PAVED OPERATION AREA
	AGRICULTURAL COVER AREA

NOTE:
THE WATER QUALITY BASIN HAS NO EXTERNAL DISCHARGE OTHER THAN TO STORMWATER BASIN #1, WHICH ULTIMATELY DISCHARGES THROUGH NPDES OUTFALLS SO-1 AND SO-1A.

FILE: W:\Projects\2009 Projects\R09-0274 Westmoreland LandDrawings\CADD\Industrial Stormwater NPDES\NPDES-IND-SW-DWG.dwg

SKELLY AND LOY, INC.
ENGINEERS-ENVIRONMENTAL CONSULTANTS
449 EISENHOWER BOULEVARD, SUITE 300
HARRISBURG, PENNSYLVANIA 17111
(717)232-0593 (800)892-6532 FAX (717)232-1799

PROJECT NO. R09-0274

DATE: JANUARY 9, 2013

DRAWING NO. **ISW-4**

SHEET 4 OF 5

"NPDES INDUSTRIAL STORMWATER OUTFALLS PLAN" FOR WESTMORELAND LAND TENASKA PENNSYLVANIA PARTNERS, LLC SOUTH HUNTINGDON TOWNSHIP WESTMORELAND COUNTY, PA

DRAINAGE AREA AND COVER MAPPING

NO.	DESCRIPTION	BY	DATE

PERSON DATE

DESIGNED 1/9/2013

DRAWN 1/9/2013

CHECKED 1/9/2013

APPROVED 1/9/2013

SCALE 1"=200'