

Application Type **Renewal**
Facility Type **CAFO**
Permit Type **Individual**

NPDES PERMIT FACT SHEET
CAFOs

Application No. **PA0281778**
APS ID **370213**
Authorization ID **1508032**

Applicant and Facility Information

Applicant Name	<u>Pleasant View Farms Inc.</u>	Farm Name	<u>Pleasant View Farms CAFO</u>
Applicant Address	<u>261 Pleasant View Farms Road</u>	Farm Address	<u>261 Pleasant View Farms Road</u>
	<u>Martinsburg, PA 16662-8723</u>		<u>Martinsburg, PA 16662-8723</u>
Applicant Contact	<u>Marshall Metzler</u>	Farm Contact	<u>Marshall Metzler</u>
Applicant Phone	<u>(814) 793-2339</u>	Farm Phone	<u>(814) 793-2339</u>
Client ID	<u>148068</u>	Site ID	<u>560017</u>
SIC Code	<u>0241</u>	Municipality	<u>North Woodbury Township</u>
SIC Description	<u>Agriculture - Dairy Farms</u>	County	<u>Blair</u>
Date Application Received	<u>November 27, 2024</u>	WQM Required	<u>Yes</u>
Date Application Accepted	<u>December 3, 2024</u>	WQM App. No.	<u>0708201</u>

Project Description Pleasant View Farms, Inc. submitted an Individual CAFO permit renewal application for their existing/expanding dairy operation.

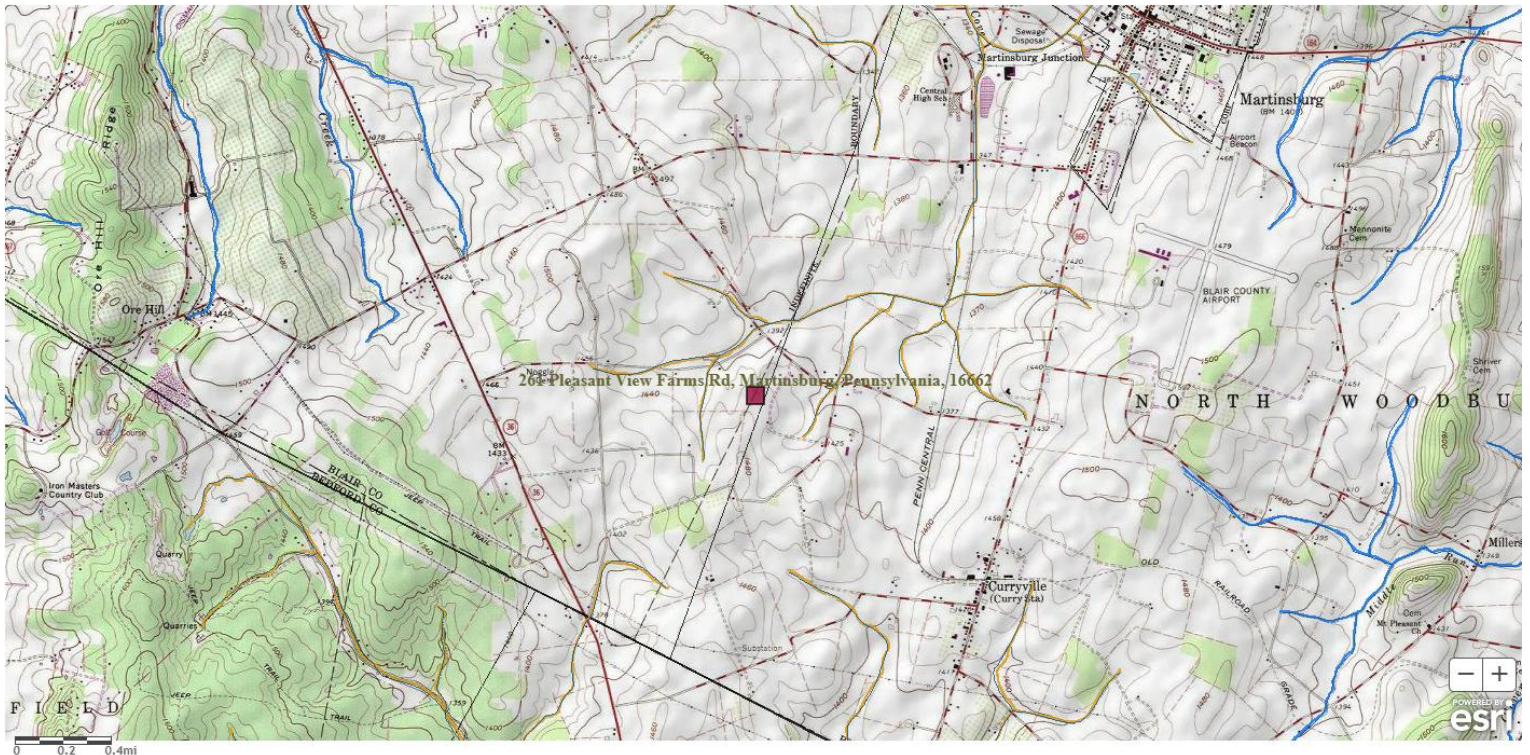

Approve	Deny	Signatures	Date
x		<i>Hans D. Shollenberger</i> Hans D. Shollenberger / Project Manager	06/17/2025
x		<i>Scott M Arwood</i> Scott M. Arwood, P.E. / Environmental Engineer Manager	06/17/2025

Description:

Pleasant View Farms, Inc. submitted an Individual CAFO permit renewal application for their existing/expanding dairy operation located in North Woodbury Township, Blair County. The operation was permitted for 4,395.05 AEUs under their CAFO permit issued effective April 1, 2020 and will be expanding to 7,281.75 AEUs with this CAFO permit renewal. The operation will have the following animal population:

Animal Type	Number	AEUs
Holstein Lactating Cow	3,785	5,488.25
Holstein Dry Cow	790	1,145.50
Holstein Heifer: 1 -2 yr.	165	165.00
Holstein Calf: 0–1 yr.	1,150	483.00
	Total AEUs =	7,281.75

The operation is not considered a CAO since the animal density does not exceed 2 AEUs/Acre. The operation is considered a large CAFO for exceeding 1,000 AEUs and for exceeding the EPA large CAFO threshold of 700 mature dairy cows.

The nearest receiving stream to the Home Site is Tributary 16534 of Plum Creek and Tributary 16533 to Plum Creek, both designated for Warm Water Fishes and Migratory Fishes (WWF, MF), located in Watershed 11-A. These streams are impaired by agriculture nutrients and siltation.

The nearest receiving stream to the Brumbaugh Slurry Store is Tributary 16534 of Plum Creek, designated for Warm Water Fishes and Migratory Fishes (WWF, MF), located in Watershed 11-A. The stream is impaired by agriculture nutrients and siltation.

The nearest receiving stream to the Hursh Farm Circular Concrete Tank is Tributary 16533 to Plum Creek, designated for Warm Water Fishes and Migratory Fishes (WWF, MF), located in Watershed 11-A. The stream is impaired by agriculture nutrients and siltation

The nearest receiving stream to the Helsel HDPE Lagoon is Tributary 13947 to Potter Creek, designated for High Quality Cold Water Fishes and Migratory Fishes (HQ-CWF, MF), located in Watershed 11-D. The stream is impaired by agriculture siltation.

The nearest receiving stream to the Frosty Hollow Concrete Round Tank is Yellow Creek, designated for High Quality Cold Water Fishes and Migratory Fishes (HQ-CWF, MF), located in Watershed 11-D. The stream is impaired by agriculture siltation.

The nearest receiving stream to the proposed Satellite HDPE-lined Lagoon is Tributary 13972 to Potter Creek, designated for High Quality Cold Water Fishes and Migratory Fishes (HQ-CWF, MF), located in Watershed 11-D. The stream is impaired by agriculture siltation.

Since the operation is located in a High Quality Watershed, the Department's Individual CAFO permit is appropriate for this operation.

Manure/Nutrient Management:

The current NMP was approved on October 17, 2024, for crop years 2025, 2026, and 2027. There are 4,107.2 acres available on lands owned/rented by the applicant for manure application according to the NMP, resulting in a density of 1.77 AEUs/acre.

Manure Group Information:

Manure Group	Manure Generated Annually	Manure Used on the Farm	Manure Exported (gallons or tons)
Home Farm Main Barn Fall	6,517,000.0 gal	10,552,450.0 gal	0.0
Home Farm Main Barn Spring	6,517,000.0 gal	13,476,450.0 gal	0.0
Home Farm Heifer Pit Fall	950,000.0 gal	1,227,000.0 gal	0.0

NPDES Permit Fact Sheet
NPDES Permit No. PA0281778
Pleasant View Farms CAFO

Home Farm Heifer Pit Spring	950,000.0 gal	1,646,400.0 gal	0.0
New Round Pit Fall	3,827,733.0 gal	3,810,300.0 gal	0.0
New Round Pit Spring	3,801,209.0 gal	3,698,750.0 gal	0.0
Slurry Store Fall	330,429.0 gal	1,354,300.0 gal	0.0
Slurry Store Spring	330,429.0 gal	991,600.0 gal	0.0
Home Farm PenPack Fall	1,875.0 tons	2,111.0 tons	0.0
Home Farm PenPack Spring	1,875.0 tons	2,175.0 tons	0.0
FH Fall	3,625,000.0 gal	5,277,300.0 gal	0.0
FH Spring	3,625,000.0 gal	6,276,050.0 gal	0.0
FH Solid	1,500.0 tons	2,044.0 tons	0.0
Helsel Lagoon	5,744,500.0 gal	5,763,750.0 gal	0.0
Hursh Pit Fall	639,139.0 gal	1,266,900.0 gal	0.0
Hursh Pit Spring	594,167.00 gal	1,596,200.00 gal	0.0

Exported Manure:

Name/ Address	Amount and Source of Manure Exported per Season (gallons/ tons)			
	Spring	Summer	Fall	Winter
Metzler LP 261 Pleasant View Farms Road Martinsburg Pa 16662	5,500 tons Dairy & 3,000,000 gallons Dairy	0	5,500 tons Dairy & 3,000,000 gallons Dairy	0

The following requirements must be met when transferring manure to other persons:

40 CFR 122.42(e)(3) - Requirements relating to transfer of manure or process wastewater to other persons.

Prior to transferring manure, litter, or process wastewater to other persons, Large CAFOs must provide the recipient of the manure, litter or process wastewater with the most current nutrient analysis. The analysis provided must be consistent with the requirements of 40 CFR part 412. Large CAFOs must retain for five years records of the date, recipient name and address, and approximate amount of manure, litter or process wastewater transferred to another person.

Winter Manure Management:

Application of manure during the winter period is approved in the NMP.

The following minimum required freeboards must be met by December 15th of each year to implement the NMP:

- Home Dairy Freestall Underbarn 6.4'
- Home Dairy Concrete Bottom Earthen Lagoon 11.5'
- Brumbaugh Slurry Store 8'
- Frosty Hollow Concrete Round Tank 12'
- Helsel HDPE Lagoon 14.2'
- Hursh Farm Circular Concrete Tank 9.9'
- Home Farm Concrete Circular 10.5'

Manure Storage Facilities:

Storage	Dimensions	Minimum Required Regulatory Freeboard	Usable Capacity (@ freeboard)
Satellite HDPE-lined Lagoon	210' x 500' x 17.5'	2'	8,311,606 gallons

NPDES Permit Fact Sheet
NPDES Permit No. PA0281778
Pleasant View Farms CAFO

Home Dairy Freestall Underbarn	110' x 551' x 9'	0.5'	4,558,485 gallons
Home Dairy Concrete Bottom Earthen Lagoon	80' x 120' x 12'	2'	368,052 gallons
Frosty Hollow Concrete Round Tank	140' x 14'	2'	1,611,222 gallons
Brumbaugh Slurry Store	62' x 19'	2'	383,710 gallons
Helsel HDPE Lagoon	185' x 275' x 16'	2'	3,275,065 gallons
Home Farm Concrete Circular Storage	16' x 180'	2'	2,663,448 gallons
Hursh Farm Circular Concrete Tank	120' x 12'	2'	845,539 gallons

Pleasant View Farms, Inc. was issued WQM 0708201 A-1 on October 7, 2024 for the construction and operation of the 16' x 180' Concrete Circular Storage.

Pleasant View Farms, Inc. was issued WQM 0708201 A-2 on February 19, 2025 for the proposed 210' x 500' x 17.5' Satellite HDPE-Lined Lagoon and for the addition of the existing Hursh Farm Circular Concrete Tank.

Prior to the final issuance of this CAFO permit renewal, the design engineer will be required to submit PE Certification for the construction of the proposed Concrete Circular Storage and proposed Satellite HDPE-Lined Lagoon.

There are no plans to field stack manure, and no planned alternative manure technology practices for this operation.

BMPs Applicable to the Chesapeake Bay TMDL:

DEP has evaluated the information included in the application materials; as well as the effluent limitations, BMPs, and other requirements included in the draft permit. This would include the approved Act 38 compliant Nutrient Management Plan, which includes Best Management Practices to meet Pennsylvania nutrient and manure management regulations, as well as Nutrient Balance Sheets for manure importers, applicable manure storage and manure spreading setback requirements, and Emergency Response Plan. Applicable Conservation Plans and/or Agricultural Erosion & Sediment Control Plans were also evaluated, which includes Best Management Practices to meet Pennsylvania erosion and sediment control regulations.

The applicant is implementing the following BMPs within the production area:

- Manure Storage Facilities
- Mortality Management (Composting)

The following NRCS Practice Codes are prescribed as BMPs in the approved 2025 to 2027 NMP for this operation:

- NRCS Practice Code 634 Waste Transfer - pipe/reception pits Leachate, Location: PVF FS, Fall 2025
- NRCS Practice Code 313 Waste Storage Facility, Location: PVF FS, Fall 2024
- NRCS Practice Code 634 Waste Transfer, Location: PVF FS, Fall 2024
- NRCS Practice Code 412 Grassed Waterway, Location: Hursh, Fall 2025

Based upon this evaluation, DEP believes no additional BMPs will be required at this time to protect water quality criteria. This determination will be reevaluated through review of self-inspection reporting, annual reporting, and regular compliance inspections.

Animal Mortality:

Mortalities are composed on the farmstead using bedded pack manure as a carbon and nitrogen source.

Animal Concentration Areas (Chapter 102.4a):

Animal Heavy Use Areas (AHUAs) are designated in the NMP, and will be managed according to the provisions of the NMP.

Chapter 102 E&S (Conservation Plans):

Agricultural E&S Plans have been included and verified to exist for land subjected to plowing and tilling activities.

Downstream Public Water Supplies:

There are no downstream public water supply intakes within 40 miles of the operation. This facility is not expected to adversely impact any public water supplies.

Compliance History:

There are no open violations for this operation.

Public Participation:

DEP will publish notice of the receipt of the NPDES permit application and a tentative decision to issue the individual NPDES permit in the *Pennsylvania Bulletin* in accordance with 25 Pa. Code § 92a.82. Upon publication in the *Pennsylvania Bulletin*, DEP will accept written comments from interested persons for a 30-day period (which may be extended for one additional 15-day period at DEP's discretion), which will be considered in making a final decision on the application. Any person may request or petition for a public hearing with respect to the application. A public hearing may be held if DEP determines that there is significant public interest in holding a hearing. If a hearing is held, notice of the hearing will be published in the *Pennsylvania Bulletin* at least 30 days prior to the hearing and in at least one newspaper of general circulation within the geographical area of the discharge.